

OVATION

H-55FC

User Manual



Model ID: OVATIONH55FC

Edition Notes

The Ovation H-55FC User Manual includes a description, safety precautions, installation, programming, operation, and maintenance instructions for the Ovation H-55FC as of the release date of this edition.

Trademarks

Chauvet, Chauvet Professional, the Chauvet logo, and Ovation are registered trademarks or trademarks of Chauvet & Sons, LLC (d/b/a Chauvet and Chauvet Lighting) in the United States and other countries. Other company and product names and logos referred to herein may be trademarks of their respective companies.

Copyright Notice

The works of authorship contained in this manual, including, but not limited to, all designs, text, and images are owned by Chauvet.

© Copyright 2025 Chauvet & Sons, LLC. All rights reserved.

Electronically published by Chauvet in the United States of America.

Manual Use

Chauvet authorizes its customers to download and print this manual for professional information purposes only. Chauvet expressly prohibits the usage, copy, storage, distribution, modification, or printing of this manual or its content for any other purpose without written consent from Chauvet.

Document Printing

For best results, print this document in color, on letter size paper (8.5 x 11 in), double-sided. If using A4 paper (210 x 297 mm), configure the printer to scale the content accordingly.

Intended Audience

Any person installing, operating, and/or maintaining this product should completely read through the guide that shipped with the product, as well as this manual, before installing, operating, or maintaining this product.

Disclaimer

Chauvet believes that the information contained in this manual is accurate in all respects. However, Chauvet assumes no responsibility and specifically disclaims any and all liability to any party for any loss, damage, or disruption caused by any errors or omissions in this document, whether such errors or omissions result from negligence, accident, or any other cause. Chauvet reserves the right to revise the content of this document without any obligation to notify any person or company of such revision, however, Chauvet has no obligation to make, and does not commit to make, any such revisions.

Document Revision

Go to www.chauvetprofessional.com for the latest version.

Revision	Date	Description
1	02/2025	Initial release

TABLE OF CONTENTS

1. Before You Begin	1
What Is Included	1
Claims	1
Text Conventions	1
Symbols	1
Safety Notes.....	2
FCC Statement of Compliance	3
RF Exposure Warning for North America and Australia.....	3
Expected LED Lifespan.....	3
2. Introduction	4
Features	4
Product Overview.....	4
Product Dimensions	5
3. Setup	6
AC Power	6
AC Plug	6
Fuse Replacement	6
DMX Linking.....	6
Alternate DMX Access Diagram.....	6
Master/Slave Connectivity.....	7
Remote Device Management.....	7
Wireless Operation.....	7
Initial Setup	7
Wireless Configuration.....	7
Configuration with RDM2go.....	7
Product Pairing with RDM2go.....	8
Mounting	8
Orientation.....	8
Rigging	8
Procedure.....	8
Sconce Mounting	9
Recess Kit Installation	10
Lenses and Filter.....	12
Egg Crate.....	12
4. Operation	13
RDM2go Programming	13
Menu Map	13
Virtual Color Wheel	15
Virtual Color Wheel Chart	15
Color Temperature Chart	16
Control Configuration	16
DMX Personalities.....	16
Starting Address.....	16
Control Channel Assignments and Values.....	17
16CH / 13CH / 12CH / 10CH	17
7CH / 5CH / 3CH	18
HSV.....	18

Standalone Configuration.....	18
Dimmer Curve	18
Dimmer Speed Mode	18
Pulse Width Modulation	18
Factory Default.....	18
Clear Device Data	18
Static Colors	19
Automatic Program	19
Automatic Program Speed.....	19
Master Slave	19
W-DMX On/Off	19
Receive Reset.....	19
Emergency Mode	19
White Balance	19
Red Shift	20
5. Maintenance.....	21
Product Maintenance	21
6. Technical Specifications	22
Contact Us	23
Warranty & Returns.....	23

Before You Begin

1. Before You Begin

What Is Included

- Ovation H-55FC
- 65°, 40°, and 25° lens
- 80° filter
- Egg crate
- Recess and scone mounting kits
- Quick Reference Guide

Claims

Carefully unpack the product immediately and check the container to make sure all the parts are in the package and are in good condition.



If the box or the contents (the product and included accessories) appear damaged from shipping, or show signs of mishandling, notify the carrier immediately, not Chauvet. Failure to report damage to the carrier immediately may invalidate the claim. In addition, keep the box and contents for inspection.

For other issues, such as missing components or parts, damage not related to shipping, or concealed damage, file a claim with Chauvet within 7 days of delivery.

Text Conventions

Convention	Meaning
1–512	A range of values
50/60	A set of values of which only one can be chosen
Settings	A menu option not to be modified
<ENTER>	A key to be pressed on the product's control panel

Symbols

Symbol	Meaning
	Critical installation, configuration, or operation information. Not following these instructions may make the product not work, cause damage to the product, or cause harm to the operator.
	Important installation or configuration information. The product may not function correctly if this information is not used.
	Useful information.

The term “DMX” used throughout this manual refers to the USITT DMX512-A digital data transmission protocol.

Connection of the control signal: DMX line



- The product has XLR sockets for DMX input and output.
- **Notice:** This control circuit is isolated and belongs to the Class 2 data port.
- The control circuit has a cumulative leakage current of less than 3.5 mA.

Safety Notes

Read all the following safety notes before working with this product. These notes contain important information about the installation, usage, and maintenance of this product.



This product contains no user-serviceable parts. Any reference to servicing in this User Manual will only apply to properly trained, certified technicians. Do not open the housing or attempt any repairs.



All applicable local codes and regulations apply to proper installation of this product.

- The luminaire is intended for professional use only.
- The luminaire should be positioned so that prolonged staring into the luminaire at a distance closer than 23.6 ft (7.2 m) is not expected.
- If the external flexible cable or cord of this luminaire is damaged, it shall be replaced by a special cord or cord exclusively available from the manufacturer or its service agent.
- The light source contained in this luminaire shall only be replaced by the manufacturer or its service agent or a similar qualified person.
- **CAUTION:**
 - This product's housing may be hot when operating. Mount this product in a location with adequate ventilation, at least 20 in (50 cm) from adjacent surfaces.
 - When transferring the product from extreme temperature environments, (e.g., cold truck to warm humid ballroom) condensation may form on the internal electronics of the product. To avoid causing a failure, allow the product to fully acclimate to the surrounding environment before connecting it to power.
 - Flashing light is known to trigger epileptic seizures. User must comply with local laws regarding notification of strobe use.
- **ALWAYS:**
 - Disconnect from power before cleaning the product or replacing the fuse.
 - Replace the fuse with the same type and rating.
 - Use a safety cable when mounting this product overhead.
 - Connect this product to a grounded and protected circuit.
- **DO NOT:**
 - Open this product. It contains no user-serviceable parts.
 - Look at the light source when the product is on.
 - Leave any flammable material within 20 cm of this product while operating or connected to power.
 - Connect this product to a dimmer or rheostat.
 - Operate this product if the housing, lenses, or cables appear damaged.
 - Operate this product outdoors or in any location where dust, excessive heat, water, or humidity may affect it (adhere to standards for the published IP rating).
- ONLY use the handles or the hanging/mounting brackets to carry this product.
- The maximum ambient temperature is 113 °F (45 °C). Do not operate this product at higher temperatures.
- The minimum startup temperature is -4°F (-20°C). Do not start the product at lower temperatures.
- The minimum ambient temperature is -22°F (-30°C). Do not operate the product at lower temperatures.
- To eliminate unnecessary wear and improve its lifespan, during periods of non-use completely disconnect the product from power via breaker or by unplugging it.
- In the event of a serious operating problem, stop using immediately.



If a Chauvet product requires service, contact Chauvet Technical Support.

Before You Begin

FCC Statement of Compliance

This device complies with Part 15 Part B of the FCC rules. Operation is subject to the following two conditions:

1. This device may not cause harmful interference, and
2. This device must accept any interference received, including interference that may cause undesired operation.

This equipment has been tested and found to comply with the limits for a Class B digital device, pursuant to Part 15 of the FCC Rules. These limits are designed to provide reasonable protection against harmful interference in a residential installation. This equipment generates uses and can radiate radio frequency energy and, if not installed and used in accordance with the instructions, may cause harmful interference to radio communications. However, there is no guarantee that interference will not occur in a particular installation. If this equipment does cause harmful interference to radio or television reception, which can be determined by turning the equipment off and on, the user is encouraged to try to correct the interference by one or more of the following measures:

- Reorient or relocate the receiving antenna.
- Increase the separation between the equipment and receiver.
- Connect the equipment into an outlet on a circuit different from that to which the receiver is connected.
- Consult the dealer or an experienced radio/TV technician for help.

Any changes or modifications not expressly approved by the party responsible for compliance could void the user's authority to operate the equipment.

RF Exposure Warning for North America and Australia

Warning! This equipment complies with FCC radiation exposure limits set forth for an uncontrolled environment. This equipment should be installed and operated with a minimum distance of 20 cm between the radiator and the user. This transmitter must not be co-located or operating in conjunction with any other antenna or transmitter.

Expected LED Lifespan

Over time, use and heat will gradually reduce LED brightness. Clustered LEDs produce more heat than single LEDs, contributing to shorter lifespans if always used at full intensity. The average LED lifespan is 40,000 to 50,000 hours. To extend LED lifespan, maintain proper ventilation around the product, and limit the overall intensity.

2. Introduction

Features

- Compact, full-color (RGBAL), convection-cooled house light
- Interchangeable lens plates to adapt to different mounting heights
- 5-pin XLR and terminal blocks for DMX connections
- Use included yoke for mounting, or suspend from integrated loop-eye
- Included recess and scone mounting kits
- 16-bit dimming for ultra-smooth fades
- DMX, W-DMX, and RDM for added programming flexibility
- Adjustable PWM to avoid flickering on camera

Product Overview

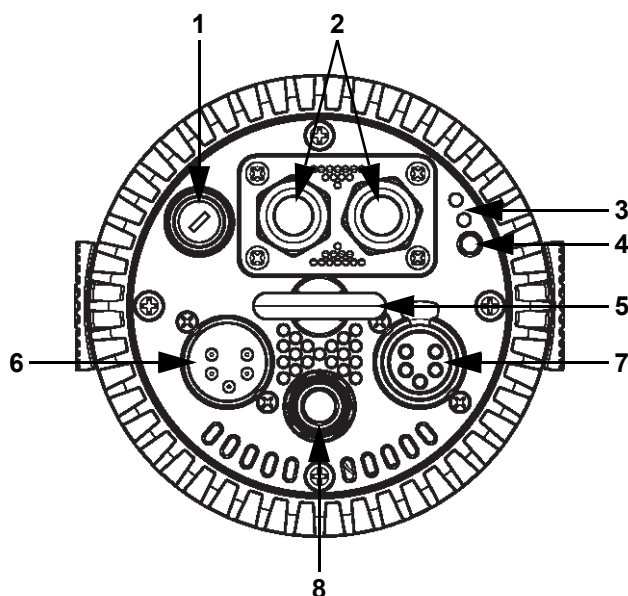

#	Name
1	Fuse holder
2	Hard-wired DMX in/out
3	Indicator LEDs
4	W-DMX button
5	Safety loop
6	DMX in
7	DMX out
8	Fixed power cable

Product Dimensions

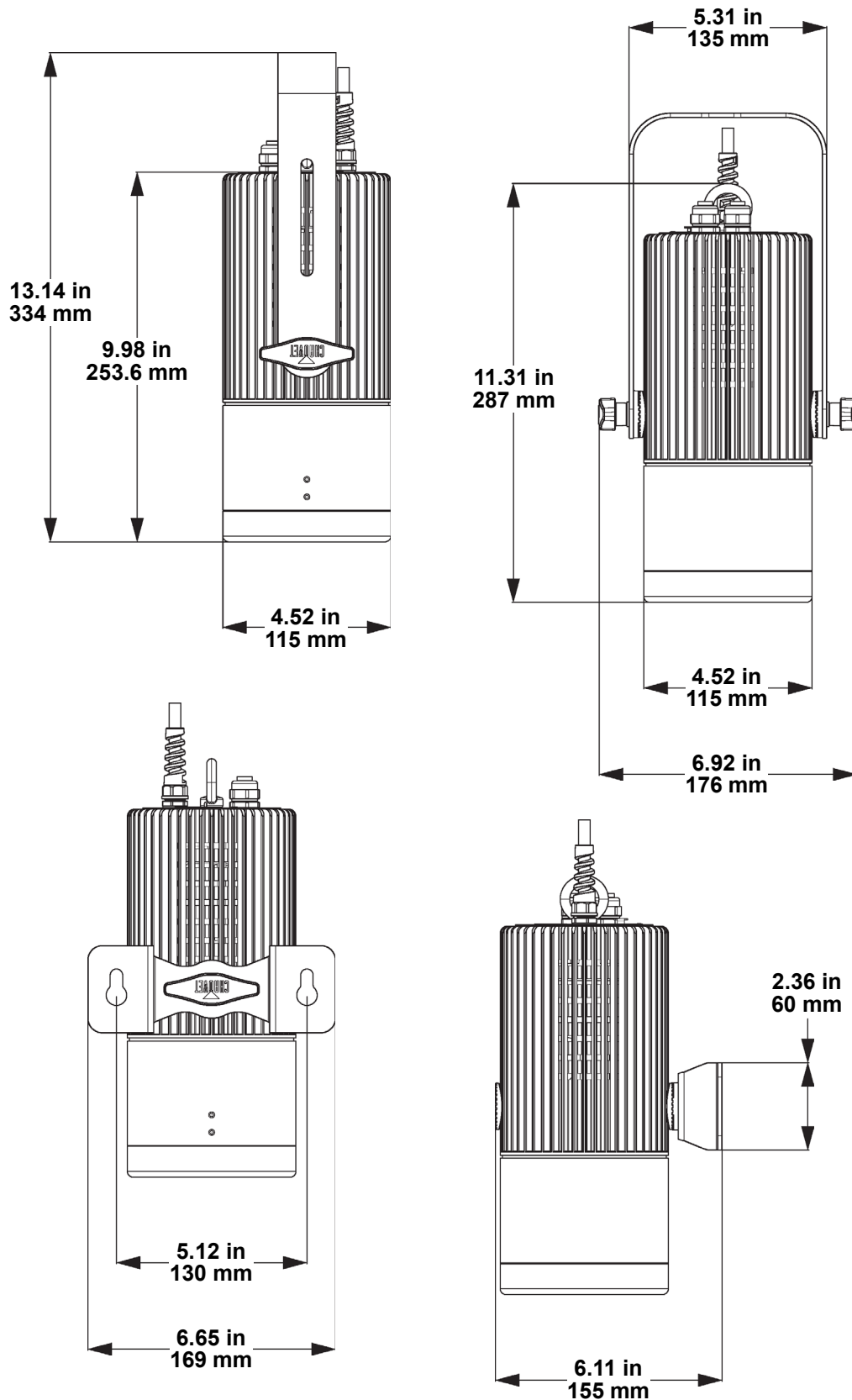

3. Setup

AC Power

The Ovation H-55FC has an auto-ranging power supply and it can work with an input voltage range of 100 to 240 VAC, 50/60 Hz.

To determine the product's power requirements (circuit breaker, power outlet, and wiring), use the current value listed on the label affixed to the product's back panel, or refer to the product's specifications chart.

The listed current rating indicates the product's average current draw under normal conditions.



- **Always connect the product to a protected circuit (a circuit breaker or fuse). Make sure the product has an appropriate electrical ground to avoid the risk of electrocution or fire.**
- **To eliminate unnecessary wear and improve its lifespan, during periods of non-use completely disconnect the product from power via breaker or by unplugging it.**



Never connect the product to a rheostat (variable resistor) or dimmer circuit, even if the rheostat or dimmer channel serves only as a 0 to 100% switch.

AC Plug

The Ovation H-55FC comes with a bare ended power input cable. The product side of this power cable enters the product through a strain reliever (rubber boot) and it cannot be disconnected from the product. Use the table below to wire a plug to the power cable.

Connection	Wire (U.S.)	Wire (Europe)	Screw Color
AC Live	Black	Brown	Yellow or Brass
AC Neutral	White	Blue	Silver
AC Ground	Green/Yellow	Green/Yellow	Green

Fuse Replacement

1. Disconnect this product from the power outlet.
2. Using a flat-head screwdriver, unscrew the fuse holder cap from the housing.
3. Remove the blown fuse and replace with another fuse of the same type and rating (T2 A, 250 V).
4. Screw the fuse holder cap back in place and reconnect power.

DMX Linking

The Ovation H-55FC can link to a DMX controller using a 5-pin DMX connection, hard wiring with the Phoenix connectors, or a wireless W-DMX connection. For more information about DMX, read the DMX primer at: https://www.chauvetprofessional.com/wp-content/uploads/2016/06/DMX_Primer.pdf.

Alternate DMX Access Diagram

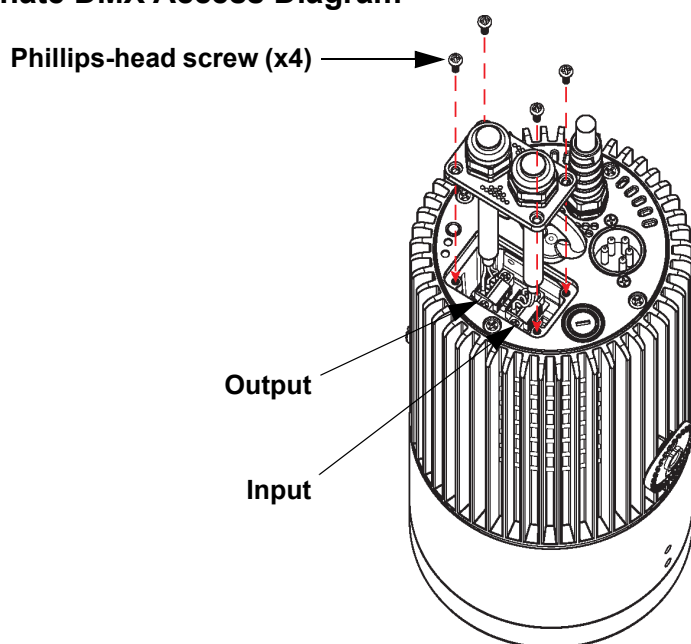

Master/Slave Connectivity

The Master/Slave mode allows a Ovation H-55FC (the master) to control one or more Ovation H-55FC products (the slaves) without a DMX controller. One Ovation H-55FC becomes the master when running an automatic program or static mode.

Each slave's control panel must be configured to operate in Slave mode. During Master/Slave operation, the slaves will operate in unison with the master.



DO NOT connect a DMX controller to products operating in Master/Slave mode. The DMX controller signals may interfere with the signals from the master.



The [Operation](#) section of this manual provides detailed instructions on how to configure the master and slaves.

Remote Device Management

Remote Device Management, or RDM, is a standard for allowing DMX-enabled devices to communicate bi-directionally along existing DMX cabling. Check the DMX controller's User Manual or with the manufacturer as not all DMX controllers have this capability. The Ovation H-55FC supports RDM protocol that allows feedback to make changes to menu map options.

Wireless Operation

In optimal conditions, the Ovation H-55FC can operate up to 300 m (900 ft) away from a W-DMX transmitter. It is necessary to pair the W-DMX receiver in this product with a W-DMX transmitter for wireless operation.

Initial Setup

1. Turn the W-DMX transmitter on.
2. Connect the W-DMX transmitter to a DMX controller.
3. Place the Ovation H-55FC within 300 m from the W-DMX transmitter.
4. Disconnect any DMX cable from the Ovation H-55FC.
5. Turn the Ovation H-55FC on.

Wireless Configuration

To configure the wireless mode, press and hold the button next to the indicator lights.

Mode	Wireless Indicator Light	Description
Off	Green/red off	Fixture is off
Receive mode	Green on, flashing slowly	In receiving mode
	Red off	Waiting for wireless connection
	Red on, solid	Connected with W-DMX Control, DMX input signal detected
	Red on, flashing slowly	Connected with W-DMX Control, no DMX input signal detected
	Red on, flashing quickly	Connected to W-DMX Control, signal is weak



W-DMX operation can be interrupted or inhibited by liquid masses between the transmitter and receiver such as water, snow, or people. For best results, keep the area between the transmitter and receiver clear of any liquid mass.



The RDM2go from Chauvet Professional, or another RDM-capable interface, is required to setup the product.

Configuration with RDM2go

To enable the Ovation H-55FC to receive W-DMX with an RDM interface:

1. Connect an RDM2go from Chauvet Professional (or another RMD-capable interface) to the DMX input of the Ovation H-55FC.
2. From the main menu, go to **Specific PIDS**.
3. Go to **8212 > W-DMX On/Off** and set the value to **1**.
4. Press the reset button on the W-DMX transmitter. (The red LED indicator on the Ovation H-55FC will be off until a connection is established. The green LED indicator will flash slowly while W-DMX is enabled)

Product Pairing with RDM2go

If the Ovation H-55FC has already been paired with the W-DMX transmitter, the red LED indicator will show the strength of the signal. In this case, the Ovation H-55FC is ready to work in wireless mode. To pair the Ovation H-55FC to a new W-DMX transmitter with an RDM interface:

1. Connect an RDM2go from Chauvet Professional (or another RDM-capable interface) to the DMX input of the Ovation H-55FC.
2. From the main menu, go to **Specific PIDS**.
3. Go to **8215 > Receive Reset** and set the value to **1**.
4. From the W-DMX transmitter, press **<RESET>** (the signal indicator on the transmitter will flash).
5. Once the transmitter has found the Ovation H-55FC, the signal indicator on the transmitter will illuminate solid.

Mounting

Before mounting the product, read and follow the safety recommendations indicated in the Safety Notes. For our Chauvet Professional line of mounting clamps, go to <http://trusst.com/products/>.

Orientation

Always mount this product in a safe position, making sure there is adequate room for ventilation, configuration, and maintenance.

Rigging

Chauvet recommends using the following general guidelines when mounting this product.

- Before deciding on a location for the product, make sure there is easy access to the product for maintenance and programming purposes.
- Make sure that the structure and attachment points can support the weight before hanging the product (see the [Technical Specifications](#) for weight information).
- When mounting the product overhead, always use a safety cable. Mount the product securely to a rigging point, whether an elevated platform or a truss.
- When rigging the product onto a truss, use a mounting clamp of appropriate weight capacity.

Procedure

The Ovation H-55FC comes with a mounting bracket to which the user can directly attach a mounting clamp (sold separately). It is also possible to remove the bracket and mount the product as a pendant from the safety loop. Make sure the mounting hardware is capable of supporting the weight of this product. For the Chauvet Professional line of mounting clamps, go to <http://www.trusst.com/products>.

Mounting Diagram

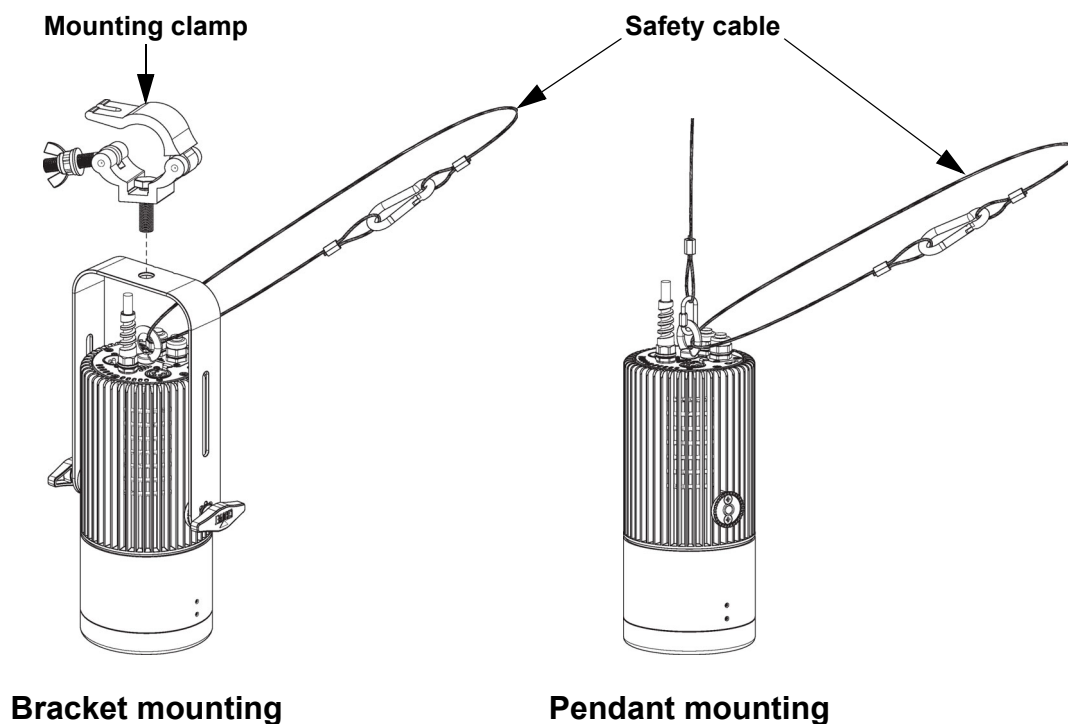

Sconce Mounting

The Ovation H-55FC comes with a sconce kit for mounting the product to a wall. To install the sconce kit to the product and mount it to a wall:

1. Remove the mounting bracket by removing the bracket adjustment knobs.
2. Remove one of the bracket mounting plates from the bracket with a Phillips-head screwdriver.
3. Install the bracket mounting plate to the sconce bracket.
4. Install the sconce bracket to the product with one of the bracket adjustment knobs.
5. Install 2 M8 screws or bolts in the desired wall at the desired position, spaced so their centers are 5.12 in (130 mm) apart horizontally.
6. Place the tear-drop holes of the sconce bracket over the screws / bolts and slide down to secure.
7. Rotate to the desired angle and secure with the bracket adjustment knob.

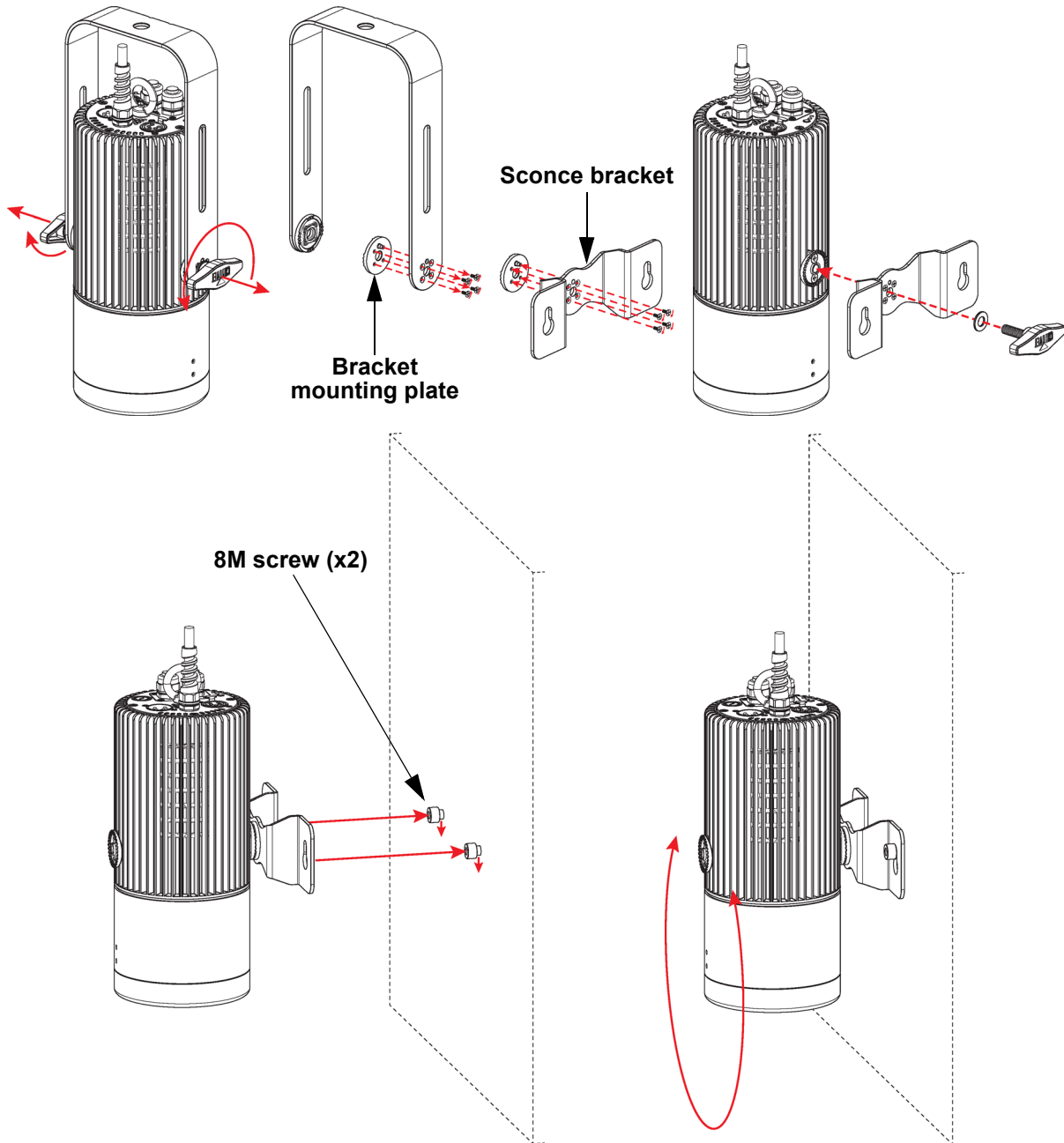

Make sure the wall and hardware are capable of supporting the weight of the product.

Recess Kit Installation

The Ovation H-55FC comes with a recess kit. Follow the instructions below to install the product to a ceiling tile.



- **Make sure the ceiling can support the weight of the product and recess kit prior to installation.**
- **It is necessary to install the product and recess kit into a plenum space with adequate room for ventilation. Do not install into a confined space without airflow.**
- **The recess kit requires a distance of at least 20 in (508 mm) from wall to ceiling in all directions.**

1. Drill a 145–160 mm hole in the center of the ceiling tile.

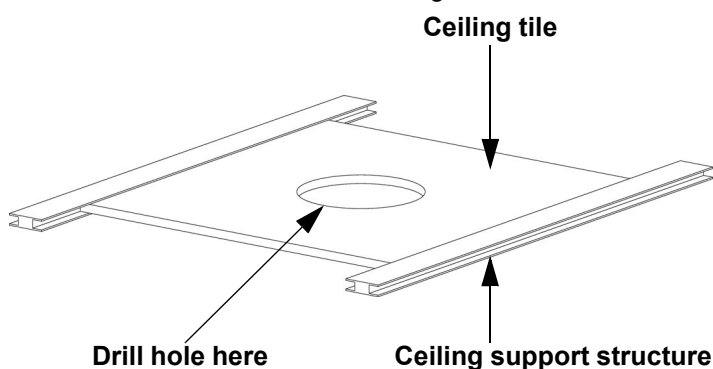

2. Attach the support rail extensions to the support rail using the included 5 mm hex screws and washers.

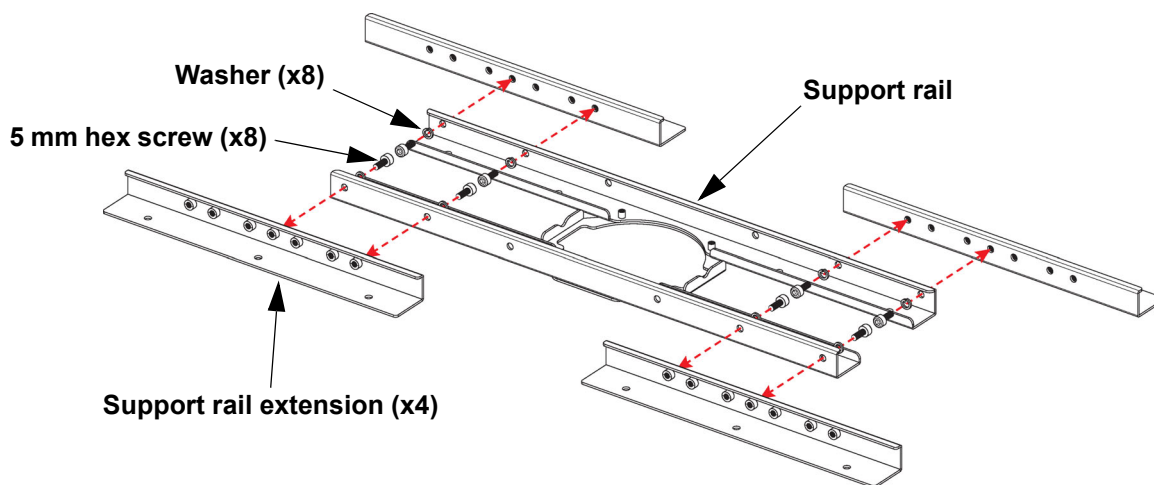

The support rail extensions provide 4 rail length options, up to a maximum of 33 in (838 mm).

3. Place the assembled support rail and extensions over the ceiling support structure and hole.

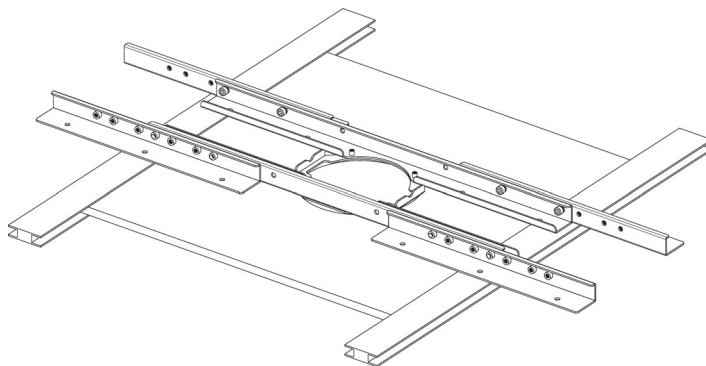

4. Insert the product into the trim ring and secure with the included short M4 screws.

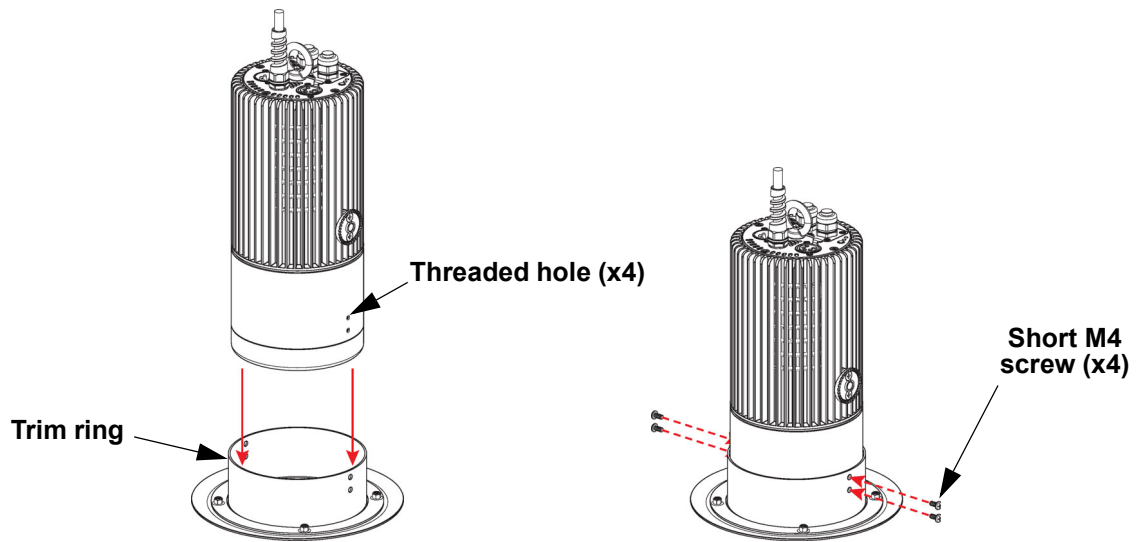

5. Install the trim ring to the support rail with the 4 included long M4 screws.

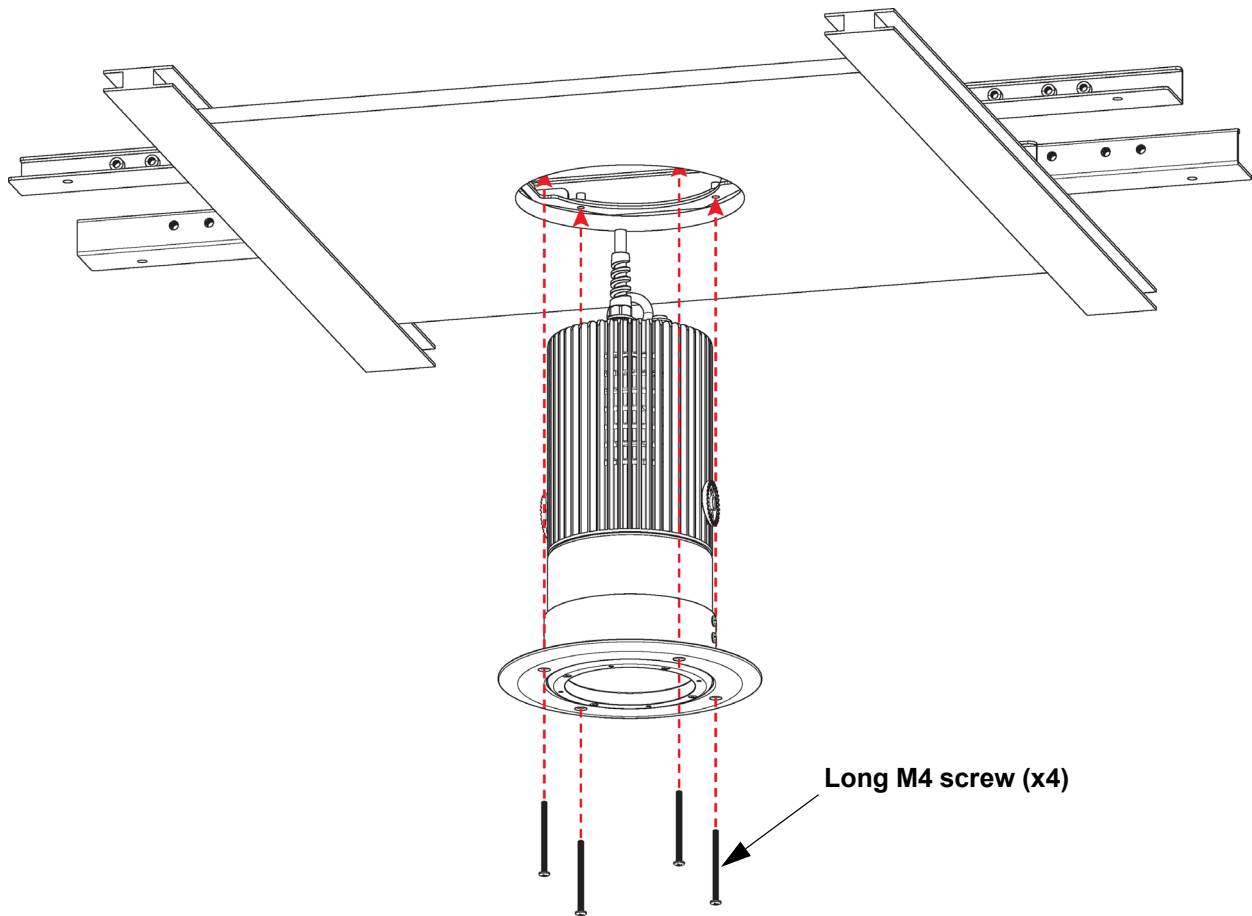

Make sure the trim ring is flush against the ceiling.

6. Installation is complete.

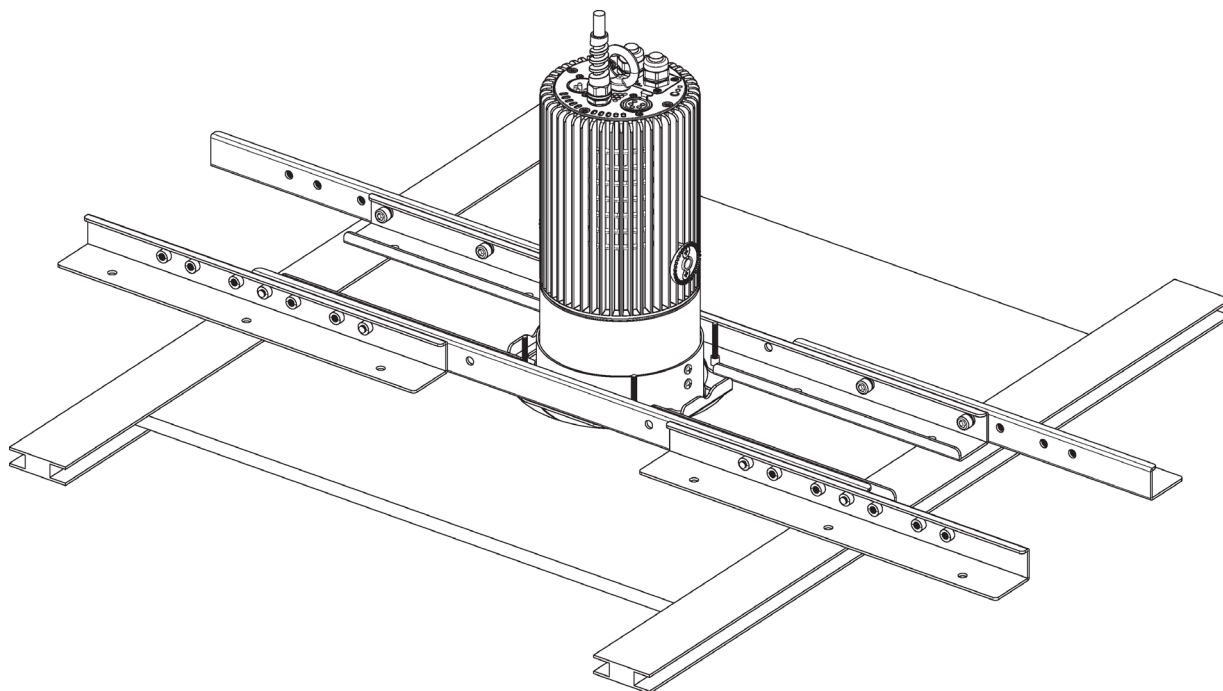

Lenses and Filter

The Ovation H-55FC comes with multiple lenses and a filter for different applications and mounting heights. To change the lens or filter:

1. Remove the front cover of the product by removing 4 hex screws.
2. Swap out the lens or filter.
3. Re-install the front cover of the product with the 4 hex screws.

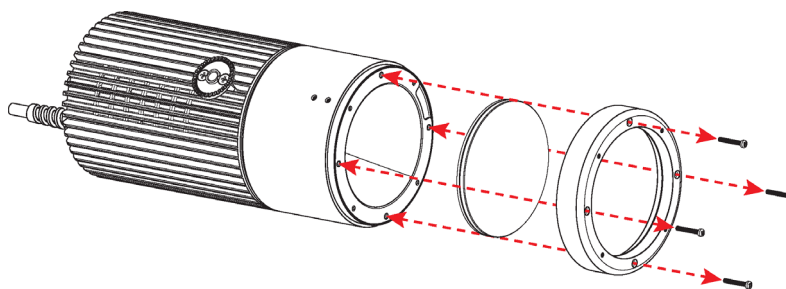

Egg Crate

The Ovation H-55FC comes with an optional egg crate which installs to the front of the product with 4 Phillips-head screws.

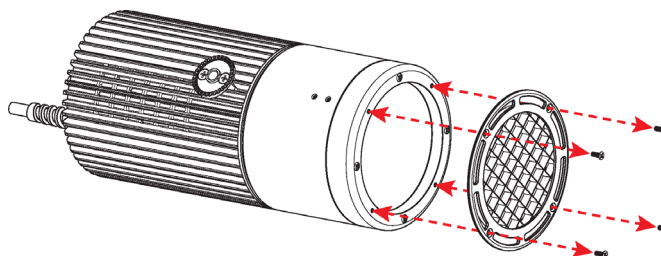

4. Operation

RDM2go Programming

The RDM2go from Chauvet Professional, or another RDM-capable interface, is required to setup and program the Ovation H-55FC. Plug the interface into the DMX input of the product to access the menu map.

Menu Map

Refer to the Ovation H-55FC product page on www.chauvetprofessional.com for the latest menu map and software.

Main Menu	Programming Levels		Description
DMX Address	Address	001–512*	Selects DMX address (*highest channel restricted to personality chosen)
DMX Channel	3Ch		3 channels: dimmer, virtual color wheel, color temperature, Red Shift
	5Ch		5 channels: RGBAL
	7Ch		7 channels: dimmer, RGBAL, Red Shift
	10Ch		10 channels: 16-bit dimmer, RGBAL, strobe, virtual color wheel, color temperature, Red Shift
	12Ch		12 channels: dimmer, RGBAL, strobe, virtual color wheel, color temperature, auto programs, auto speed, dimmer speed, Red Shift
	13Ch		13 channels: 16-bit dimmer, 16-bit RGBAL, Red Shift
	16Ch		16 channels: 16-bit dimmer, 16-bit RGBAL, strobe, virtual color wheel, color temperature, Red Shift
	HSV		3-channel: hue, saturation, value
Dimmer Curve	SCurve		Sets the dimmer curve
	Linear		
	Square		
	Inverse Square		
Dimmer Mode	Off		Instantaneous dimmer
	Dimmer 1–3		Dimmer mode, fast (1) to slow (3)
LED Frequency	600Hz		Sets the Pulse Width Modulation frequency
	1200Hz		
	2000Hz		
	4000Hz		
	6000Hz		
	25KHz		
Factory Reset	No		Resets the product to factory default settings
	Yes		

Main Menu	Programming Levels			Description
Specific PIDS	82C8	Clean All Data	0	No
			1	Yes
	8218	Static-Red	0–255	Dimmer (0–100%)
	8219	Static-Green	0–255	Strobe (0–100%)
	8220	Static-Blue	0–255	Strobe (0–100%)
	8221	Static-Amber	0–255	Strobe (0–100%)
	8222	Static-Lime	0–255	Strobe (0–100%)
	8209	Auto Show	1–4	Selects automatic programs
	8210	Auto Speed	1–100	Sets program speed
	8211	Master/Slave	0	Master mode
			1	Slave mode
	8212	W-DMX On/Off	0	W-DMX off
			1	W-DMX on
	8215	Receive Reset	0	Do not reset wireless signal
			1	Reset wireless signal
	8216	Emergency Mode	0	Emergency mode off
			1	Emergency mode on
	8200	White Balance-Red	125–255	Sets red LED maximum value
	8201	White Balance-Green	125–255	Sets green LED maximum value
	8202	White Balance-Blue	125–255	Sets blue LED maximum value
	8204	White Balance-Amber	125–255	Sets amber LED maximum value
	8205	White Balance-Lime	125–255	Sets lime LED maximum value
	82BC	Red Shift	0	Disables Red Shift
			1	Enables Red Shift

Virtual Color Wheel

The Ovation H-55FC includes a feature called the Virtual Color Wheel (VCW). This feature is available as a standalone control mode for manual use and as a control channel in select DMX personalities. More than 30 premixed colors, custom blended by Chauvet engineers, are available to call up for easier programming.

The DMX values used to mix these colors are provided below. The overall intensity of the Ovation fixture can be adjusted to more closely replicate familiar industry-standard colors. A chart is available at www.chauvetprofessional.com to compare Chauvet's premixed colors with popular gel colors. This chart is for comparison purposes only and is not an assertion that Chauvet's premixed colors match any of the gel colors listed.

Virtual Color Wheel Chart

DMX Value	Color	Red	Green	Blue	Amber	Lime
000 ⇔ 005		000	000	000	000	000
006 ⇔ 013	C3050-Md Yellow	210	255	003	255	157
014 ⇔ 021	C3040-Lt Yellow	244	167	010	216	213
022 ⇔ 028	C3240-Amb Yellow	208	105	000	255	234
029 ⇔ 035	C2340-VLt Amber	254	049	026	255	255
036 ⇔ 043	C2040-Lt Amber	255	046	020	255	255
044 ⇔ 051	C2050-Md Amber	255	027	002	255	126
052 ⇔ 059	C2060-Dk Amber	255	008	002	255	098
060 ⇔ 067	C1050-Lt Red	255	021	003	000	000
068 ⇔ 075	C1080-Md Red	255	000	001	000	000
076 ⇔ 083	C1020-NC Pink	255	255	051	255	016
084 ⇔ 091	C1030-Md Pink	255	205	051	255	000
092 ⇔ 099	C1630-Dk Pink	255	148	060	255	214
100 ⇔ 107	C1250-Md Red Amber	255	000	008	255	004
108 ⇔ 115	C1060-Dk Red Amber	255	000	011	110	000
116 ⇔ 121	C1650-Magenta	255	052	050	255	041
122 ⇔ 130	C6170-Dk Magenta	255	000	075	034	000
131 ⇔ 138	C6020-Lt Lavender	090	117	077	255	255
139 ⇔ 146	C5030-Lt Blue	000	255	123	006	255
147 ⇔ 154	C5020-VLt Blue	023	255	126	061	255
155 ⇔ 162	C5430-Lt Blue2	000	255	116	000	255
163 ⇔ 170	C5070-Blue	000	255	139	000	033
171 ⇔ 178	C5050-Md Blue	000	255	128	048	033
179 ⇔ 186	C5060-Dk Blue	000	255	174	000	039
187 ⇔ 194	C5690-Indigo	002	024	255	055	001
195 ⇔ 202	C5080-VDk Blue	000	255	229	000	000
203 ⇔ 210	C5081-VdK Blue2	000	237	255	000	024
211 ⇔ 218	C4370-Yel Green	000	255	005	017	010
219 ⇔ 226	C4070-Green	042	255	010	010	001
227 ⇔ 234	C4550-Turquoise	000	255	046	016	255
235 ⇔ 242	C4560-Aqua	015	255	053	017	167
243 ⇔ 250	C4570-Blue Green	000	255	025	000	028
251 ⇔ 255		000	000	000	000	000



The colors above are simulated renditions of the color output produced compared with other similar incandescent products. Chauvet makes no guarantee of the color output accuracy.

Color Temperature Chart

DMX Value	Color Temperature	Red	Green	Blue	Amber	Lime
000 ⇔ 005	No function	000	000	000	000	000
006 ⇔ 025	2800K	152	133	050	255	255
026 ⇔ 050	3000K	139	149	061	255	255
051 ⇔ 075	3200K	124	163	069	255	255
076 ⇔ 100	3500K	117	196	080	255	255
101 ⇔ 125	4000K	101	232	105	255	255
126 ⇔ 150	4500K	091	255	122	210	249
151 ⇔ 175	5000K	076	255	130	180	238
176 ⇔ 200	5600K	065	255	143	163	222
201 ⇔ 225	6000K	058	255	150	155	219
226 ⇔ 250	6500K	053	255	157	146	212
251 ⇔ 255	No function	000	000	000	000	000



The color temperatures above are simulated renditions of the color output produced as compared to a tungsten lamp at the specified color temperature. Chauvet makes no guarantee of the color output accuracy.

Control Configuration

Use an RDM2go from Chauvet Professional (or another RDM-capable interface) to set the control configurations and operate the product with a DMX controller.

DMX Personalities

To set the DMX personality:

1. Go to the **DMX Channel** main level.
2. Select the desired personality, from **3CH**, **5CH**, **7CH**, **10CH**, **12CH**, **13CH**, **16CH**, or **HSV**.



- See the [Starting Address](#) section for the highest selectable starting address for each personality.
- Make sure that the starting addresses on the various products do not overlap due to the new personality setting.

Starting Address

Each product will respond to a unique starting address from the controller. All products with the same starting address will respond in unison. To set the starting address in DMX mode:

1. Go to the **DMX Address** main level.
2. Select the starting address (**001–512**).

Personality	Highest Address
3CH	510
5CH	508
7CH	506
10CH	503
12CH	501
13CH	500
16CH	497
HSV	510

Control Channel Assignments and Values

16CH / 13CH / 12CH / 10CH

10CH	12CH	13CH	16CH	Function	Value	Percent/Setting
1	1	1	1	Dimmer	000 ⇔ 255	0–100%
2	–	2	2	Fine dimmer	000 ⇔ 255	0–100% (16-bit)
3	2	3	3	Red	000 ⇔ 255	0–100%
–	–	4	4	Fine red	000 ⇔ 255	0–100% (16-bit)
4	3	5	5	Green	000 ⇔ 255	0–100%
–	–	6	6	Fine green	000 ⇔ 255	0–100% (16-bit)
5	4	7	7	Blue	000 ⇔ 255	0–100%
–	–	8	8	Fine blue	000 ⇔ 255	0–100% (16-bit)
6	5	9	9	Amber	000 ⇔ 255	0–100%
–	–	10	10	Fine amber	000 ⇔ 255	0–100% (16-bit)
7	6	11	11	Lime	000 ⇔ 255	0–100%
–	–	12	12	Fine lime	000 ⇔ 255	0–100% (16-bit)
8	7	13	13	Strobe	000 ⇔ 010 011 ⇔ 255	No function Strobe, slow to fast
9	8	–	14	Virtual Color Wheel	000 ⇔ 255	See Virtual Color Wheel
10	9	–	15	Color Temperature	000 ⇔ 255	See Color Temperature Chart
–	10	–	–	Automatic programs	000 ⇔ 010 011 ⇔ 060 061 ⇔ 110 111 ⇔ 160 161 ⇔ 210 211 ⇔ 255	No function Auto program 1 Auto program 2 Auto program 3 Auto program 4 Auto program 5 (Auto programs 1-4)
–	11	–	–	Program speed	000 ⇔ 255	Automatic program speed, slow to fast
–	12	–	16	Control (hold for 3 seconds)	000 ⇔ 007 008 ⇔ 015 016 ⇔ 023 024 ⇔ 031 032 ⇔ 039 040 ⇔ 047 048 ⇔ 055 056 ⇔ 063 064 ⇔ 071 072 ⇔ 079 080 ⇔ 087 088 ⇔ 095 096 ⇔ 255	No function Dimmer reset Red shift on Red shift off S-curve dimmer Linear dimmer Square dimmer curve Inverse square dimmer curve Dimmer speed mode OFF Dimmer speed 1 (fastest) Dimmer speed 2 Dimmer speed 3 (slowest) No function

7CH / 5CH / 3CH

3CH	5CH	7CH	Function	Value	Percent/Setting
1	–	1	Dimmer	000 ⇄ 255	0–100%
2	–	–	Virtual Color Wheel	000 ⇄ 255	See Virtual Color Wheel
3	–	–	Color Temperature	000 ⇄ 255	See Color Temperature Chart
–	1	2	Red	000 ⇄ 255	0–100%
–	2	3	Green	000 ⇄ 255	0–100%
–	3	4	Blue	000 ⇄ 255	0–100%
–	4	5	Amber	000 ⇄ 255	0–100%
–	5	6	Lime	000 ⇄ 255	0–100%
–	–	7	Strobe	000 ⇄ 010 011 ⇄ 255	No function Strobe, slow to fast

HSV

Channel	Function	Value	Percent/Setting
1	Hue	000 ⇄ 255	0–100%
2	Saturation	000 ⇄ 255	0–100%
3	Value	000 ⇄ 255	0–100%

Standalone Configuration

Use an RDM2go from Chauvet Professional (or another RDM-capable interface) to set the product to run in a standalone mode.

Dimmer Curve

To set the dimmer curve:

1. Go to the **Dimmer Curve** in the main level.
2. Select the dimmer curve, from **SCurve**, **Linear**, **Square**, or **Inverse Square**.

Dimmer Speed Mode

To set the dimmer speed mode:

1. Go to the **Output Response Time** in the main level.
2. Select the dimmer speed, from **Off**, **Dimmer 1**, **Dimmer 2**, or **Dimmer 3**.

Pulse Width Modulation

To adjust the LED frequency:

1. Go to the **PWM Modulation** in the main level.
2. Select the frequency, from **600Hz**, **1200Hz**, **2000Hz**, **4000Hz**, **6000Hz**, or **25KHz**.

Factory Default

To reset the product to factory settings:

1. Go to the **Factory Defaults** in the main level.
2. Select **Get Factory Defaults** to confirm that the factory settings are **True** or **False**.
3. Select **Set Factory Defaults** to choose the settings from, **Single Device**, **Specific Manufacture**, or **All Manufactures**.

Clear Device Data

To reset the device hours counter of the product:

1. Go to the **Specific PIDS** main level.
2. Go to **82C8 > Clean All Data**.
3. Go to Set Value and set value from, **0** (No) or **1** (Yes).

Operation

Static Colors

To set the standalone dimmer of the product:

1. Go to the **Specific PIDS** in the main level.
2. Go to the following sub-levels to adjust a specific color:
 - **8218 > Static-Red**
 - **8219 > Static-Green**
 - **8220 > Static-Blue**
 - **8221 > Static-Amber**
 - **8222 > Static-Lime**
3. Go to **Set Value** and select from **0–255**.

Automatic Program

To set the product to run a standalone automatic program:

1. Go to the **Specific PIDS** in the main level.
2. Go to **8209 > Auto Show**.
3. Go to **Set Value** and select an automatic program from **1–5**.

Automatic Program Speed

To set the standalone automatic program speed of the product:

1. Go to the **Specific PIDS** in the main level.
2. Go to **8210 > Auto Speed**.
3. Go to **Set Value** and select the speed value from **1–100**.

Master Slave

To configure the product to act as a master or slave:

1. Go to the **Specific PIDS** in the main level.
2. Go to **8211 > Master/Slave**.
3. Go to **Set Value** and select **0** (master) or **1** (slave).

W-DMX On/Off

To enable the wireless DMX mode of the product:

1. Go to the **Specific PIDS** in the main level.
2. Go to **8212 > W-DMX On/Off**.
3. Go to **Set Value** and select **0** (Off) or **1** (On).

Receive Reset

To reset the wireless DMX signal of the product:

1. Go to the **Specific PIDS** in the main level.
2. Go to **8215 > Receive Reset**.
3. Go to **Set Value** and select **0** (No) or **1** (Yes).

Emergency Mode

To enable the emergency mode of the product to activate in the event of DMX signal loss:

1. Go to the **Specific PIDS** in the main level.
2. Go to **8216 > Emergency Mode**.
3. Go to **Set Value** and select **0** (Off) or **1** (On).

White Balance

To set each static color to its maximum value:

1. Go to the **Specific PIDS** in the main level.
2. Go to the following sub-levels to adjust a specific color:
 - **8200 > White Balance-Red**
 - **8201 > White Balance-Green**
 - **8202 > White Balance-Blue**
 - **8204 > White Balance-Amber**
 - **8205 > White Balance-Lime**
3. Go to **Set Value** and select from **125–255**.

Red Shift

The Red Shift function causes the amber LEDs to imitate the appearance of a halogen lamp when dimming. To adjust the Red Shift function, do the following:

1. Go to the **Specific PIDS** in the main level.
2. Go to **82BC > Red Shift**.
3. Go to **Set Value** and select **0 (Off)** or **1 (On)**.

5. Maintenance

Product Maintenance

Dust build-up reduces light output performance and can cause overheating. This can lead to reduction of the light source's life and/or mechanical wear. To maintain optimum performance and minimize wear, clean each lighting product at least twice a month. However, be aware that usage and environmental conditions could be contributing factors to increase the cleaning frequency.

To clean the product, follow the instructions below:

1. Unplug the product from power.
2. Wait until the product is at room temperature.
3. Use a vacuum (or dry compressed air) and a soft brush to remove dust collected on the external surface/vents.
4. Clean all transparent surfaces with a mild soap solution, ammonia-free glass cleaner, or isopropyl alcohol.
5. Apply the solution directly to a soft, lint free cotton cloth or a lens cleaning tissue.
6. Softly drag any dirt or grime to the outside of the transparent surface.
7. Gently polish the transparent surfaces until they are free of haze and lint.



Always dry the transparent surfaces carefully after cleaning them.

6. Technical Specifications

Dimensions and Weight

Length	Width	Height	Weight
13.14 in (334 mm)	6.92 in (176 mm)	4.52 in (115 mm)	7.4 lb (3.4 kg)

Note: Dimensions in inches are rounded.

Power

Power Supply Type	Range	Voltage Selection
Switching (internal)	100–240 VAC, 50/60 Hz	Auto-ranging

Parameter	100 V, 60 Hz	120 V, 60 Hz	208 V, 60 Hz	230 V, 50 Hz	240 V, 50 Hz
Consumption	63 W	53 W	57 W	58 W	65 W
Operating current	0.625 A	0.446 A	0.278 A	0.249 A	0.280 A
Fuse	T2 A, 250 V	T2 A, 250 V	T2 A, 250 V	T2 A, 250 V	T2 A, 250 V

Power I/O	US/Canada	UK/Worldwide
Fixed power cord	Bare-wired	Bare-wired

Light Source

Type	Color	Quantity	Power	Current	Lifespan
LED	Red	6	2.62–5.25 W	840 mA	50,000 hours
	Green	6			
	Blue	6			
	Amber	4			
	Lime	4			

Photometrics

Lens / Filter	Beam Angle	Field Angle	Illuminance @ 5 m	Lumens
80° filter	22.4°	49°	523 lux	3,024
65° lens	63.3°	86.9°	115 lux	2,928
40° lens	38.8°	78.4°	173 lux	2,691
25° lens	24.7°	46.7°	430 lux	2,849
25° egg crate	20.8°	39.8°	200 lux	–

Thermal

Minimum External Temp.	Maximum External Temp.	Cooling
–4 °F (–20 °C)	113 °F (45 °C)	Convection

DMX

I/O Connector	Channel Range
5-pin XLR, W-DMX	3, 5, 7, 10, 12, 13, 16, HSV

Ordering

Product	Item Name	Item Code	UPC Number
Ovation H-55FC (Black)	OVATIONH55FCBLKH2	03031727	781462223144
Ovation H-55FC (White)	OVATIONH55FCWHTH2	03031726	781462223137



RoHS



Contact Us

General Information	Technical Support
Chauvet World Headquarters	
Address: 3360 Davie Rd., Suite 509 Davie, FL 33314 Voice: (954) 577-4455 Fax: (954) 929-5560 Toll Free: (800) 762-1084	Voice: (844) 393-7575 Fax: (954) 756-8015 Email: chauvetcs@chauvetlighting.com Website: www.chauvetprofessional.com
Chauvet U.K.	
Address: Pod 1 EVO Park Little Oak Drive, Sherwood Park Nottinghamshire, NG15 0EB UK Voice: +44 (0) 1773 511115 Fax: +44 (0) 1773 511110	Email: UKtech@chauvetlighting.eu Website: www.chauvetprofessional.eu
Chauvet Benelux	
Address: Vaartlaan 9 9800 Deinze Belgium Voice: +32 9 388 93 97	Email: BNLtech@chauvetlighting.eu Website: www.chauvetprofessional.eu
Chauvet France	
Address: 3, Rue Ampère 91380 Chilly-Mazarin France Voice: +33 1 78 85 33 59	Email: FRtech@chauvetlighting.fr Website: www.chauvetprofessional.eu
Chauvet Germany	
Address: Bruno-Bürgel-Str. 11 28759 Bremen Germany Voice: +49 421 62 60 20	Email: DEtech@chauvetlighting.de Website: www.chauvetprofessional.eu
Chauvet Mexico	
Address: Av. de las Partidas 34 - 3B (Entrance by Calle 2) Zona Industrial Lerma Lerma, Edo. de México, CP 52000 Voice: +52 (728) 690-2010	Email: servicio@chauvet.com.mx Website: www.chauvetprofessional.mx

Warranty & Returns

For warranty terms and conditions and return information, please visit our website.

For customers in the United States and Mexico: www.chauvetlighting.com/warranty-registration.

For customers in the United Kingdom, Republic of Ireland, Belgium, the Netherlands, Luxembourg, France, and Germany: www.chauvetlighting.eu/warranty-registration.