

CONNECTFX

User Manual



Model ID: CONNECTFX

Edition Notes

The ConnectFX User Manual includes a description, safety precautions, installation, programming, operation, and maintenance instructions for the ConnectFX as of the release date of this edition.

Trademarks

Chauvet, Chauvet Professional, the Chauvet logo, ConnectFX, and Connect are registered trademarks or trademarks of Chauvet & Sons, LLC (d/b/a Chauvet and Chauvet Lighting) in the United States and other countries. Other company and product names and logos referred to herein may be trademarks of their respective companies.

Copyright Notice

The works of authorship contained in this manual, including, but not limited to, all designs, text, and images are owned by Chauvet.

© Copyright 2025 Chauvet & Sons, LLC. All rights reserved.

Electronically published by Chauvet in the United States of America.

Manual Use

Chauvet authorizes its customers to download and print this manual for professional information purposes only. Chauvet expressly prohibits the usage, copy, storage, distribution, modification, or printing of this manual or its content for any other purpose without written consent from Chauvet.

Document Printing

For best results, print this document in color, on letter size paper (8.5 x 11 in), double-sided. If using A4 paper (210 x 297 mm), configure the printer to scale the content accordingly.

Intended Audience

Any person installing, operating, and/or maintaining this product should completely read through the guide that shipped with the product, as well as this manual, before installing, operating, or maintaining this product.

Disclaimer

Chauvet believes that the information contained in this manual is accurate in all respects. However, Chauvet assumes no responsibility and specifically disclaims any and all liability to any party for any loss, damage, or disruption caused by any errors or omissions in this document, whether such errors or omissions result from negligence, accident, or any other cause. Chauvet reserves the right to revise the content of this document without any obligation to notify any person or company of such revision. However, Chauvet has no obligation to make, and does not commit to make, any such revisions.

Document Revision

Go to www.chauvetprofessional.com for the latest version.

Revision	Date	Description
1	11/2025	Initial release.

TABLE OF CONTENTS

2. Setup	2
Downloading the App	2
Connecting Products to WELL CONNECT	2
Mode	2
APP Mode	2
Linking	2
Home	3
Connecting to the WELL CONNECT Via Bluetooth	3
Software Update	7
Project	8
New Project	8
Export Project	8
Import Project	9
Link Fixtures	11
Link Fixtures	11
Unlink Fixtures	11
Settings	12
Advanced Fixture Settings	12
Privacy and Security Notice	13
Developer Settings	13
Help	14
Q & A	14
Help Videos	15
Contact Us	16
Fixtures	18
List	18
Add Fixtures	18
Add a Custom Fixture	21
Edit Fixtures	23
Plot	24
Placing Fixtures	24
Removing Fixtures	26
3. Operation	27
Live	27
All Fixtures	27
Effects	28
Intensity and Strobe	36
Add a New Grouping	38
Create a Group	40
Edit Grouping	42
Delete Grouping	43
Edit Group Effects	44
Add a Scene	45
Scenes	47
Master Settings	47
Scene Settings	49
Edit Scene Effects	49
Copy a Scene	51
Delete a Scene	52
Edit Group Effects	53
4. Contact Us	54
Warranty & Returns	54

2. Setup

Downloading the App

The Connect FX app is available from the Google Play Store or the Apple App Store. The WELL CONNECT wireless transceiver is not required at the time of downloading or installing the app, but it is required to control lights. For more information about downloading and installing apps onto your mobile device, see the documentation that came with your mobile device.

Connecting Products to WELL CONNECT

Mode

The Mode option permits users to select a control protocol through which the ConnectFX will connect with a product. To set the protocol that functions with the Connect FX app, follow the instructions below.

APP Mode

The WELL CONNECT can connect to a product via APP Mode. It is first necessary to connect a mobile device to the WELL CONNECT via Bluetooth. For further instructions on how to connect the WELL CONNECT to the app, see [Connecting to the WELL CONNECT Via Bluetooth](#).

Once mobile device is connected to the WELL CONNECT, APP Mode control is possible. To connect and control products in this mode:

1. Ensure that the fixture to be paired is set to receive wireless signal from the WELL Connect.
2. On the WELL CONNECT, navigate the main menu to select the **Mode** option.
3. In the **Mode** menu, select **APP Mode**.
4. Once **APP Mode** is selected, it will be possible to connect and control the desired fixture via the mobile device.

Linking

Once a protocol has been selected, it may be necessary to link the WELL CONNECT box to a product. to link a product to the ConnectFX:

1. Go to the **Linking** main menu.
2. Select **Link** or **Unlink**.



The Linking function may also serve as a Receive Reset function.

Home

Connecting to the WELL CONNECT Via Bluetooth

The WELL CONNECT generates a Bluetooth signal, which a mobile device running the Connect FX app must connect to in order to control any lights. To connect to the integrated Bluetooth using the Connect FX app:

1. Hold **<PWR>** for 3 seconds to power on the WELL CONNECT.
2. Ensure Bluetooth is enabled on the mobile device.
3. On the Connect FX app, select the **Home** tab. The app will display an “Offline” screen if a Bluetooth connection is not established.

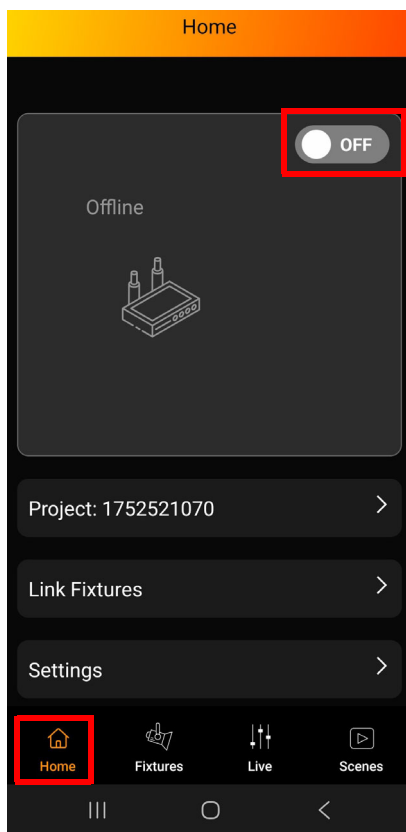

4. Select the **Off** button to change status to **On**.

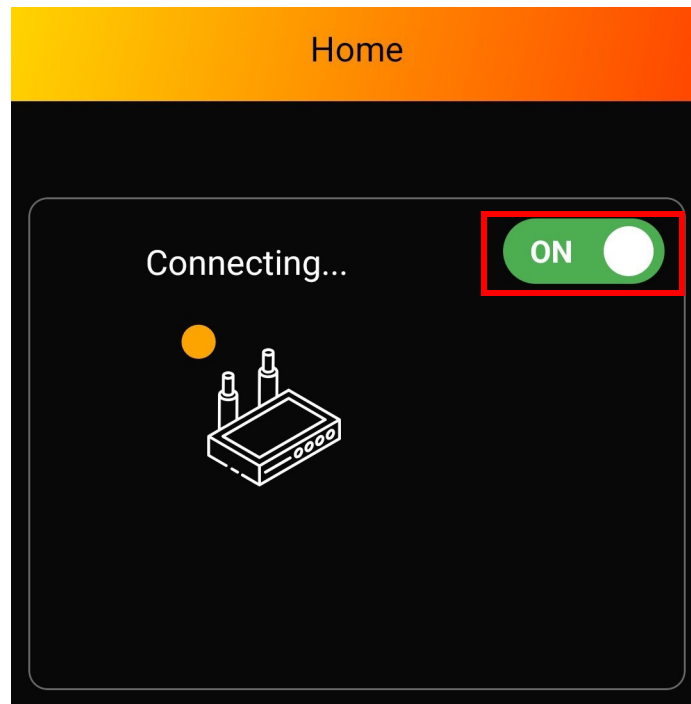

5. Allow the Connect FX app to access the device's location by selecting **While using the app** or **Only this time**.

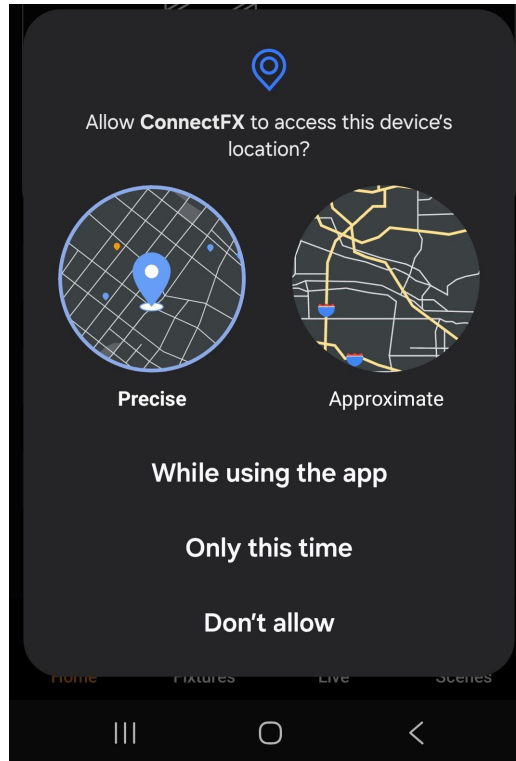

6. Select **Allow** to permit the app to find nearby devices.

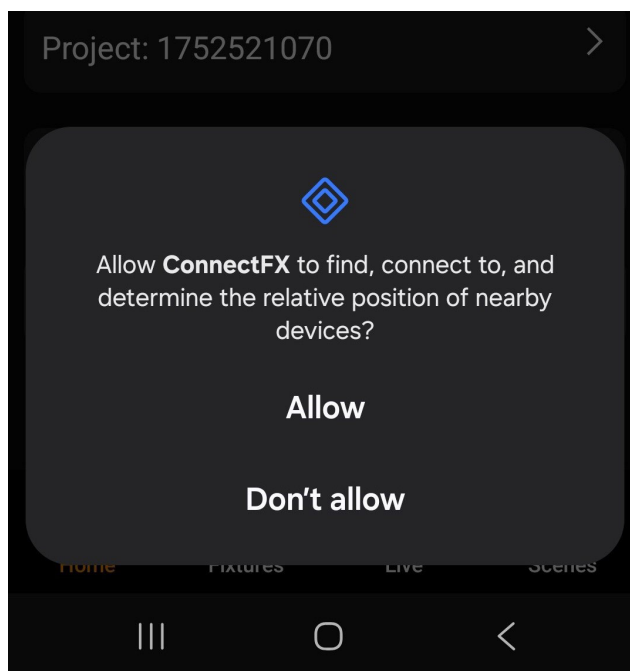

7. If the existing project on the WELL CONNECT differs from the project on the user's mobile device, the Connect FX app will prompt the user to either **Copy project from box**, or **Overwrite project on box**.

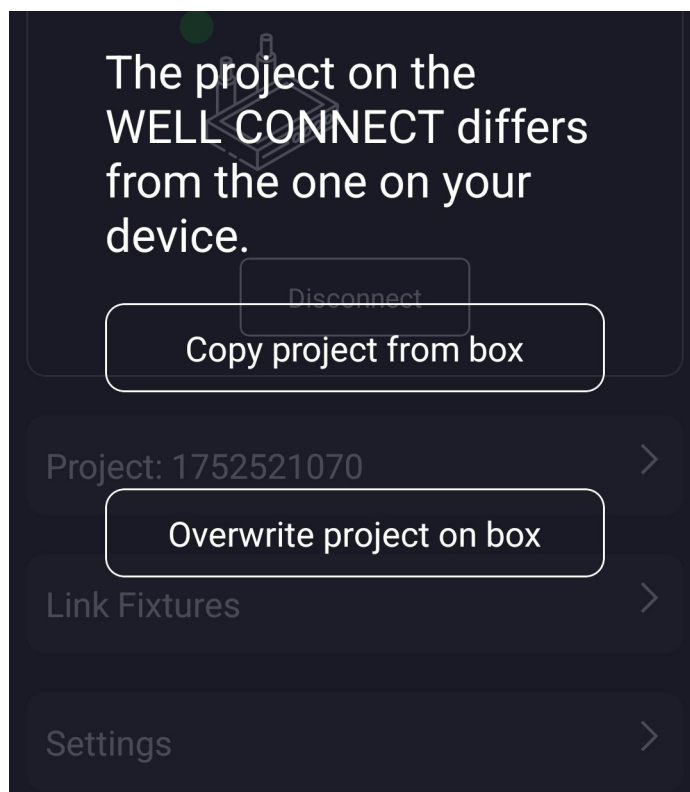

Copying the project from the box will allow users to view/edit the existing show on the box, while Overwriting the project on the box will allow users to create a new show on the App and save it over the existing show on the box.

8. If connection attempt should fail, the display will read **Connection Failed**.

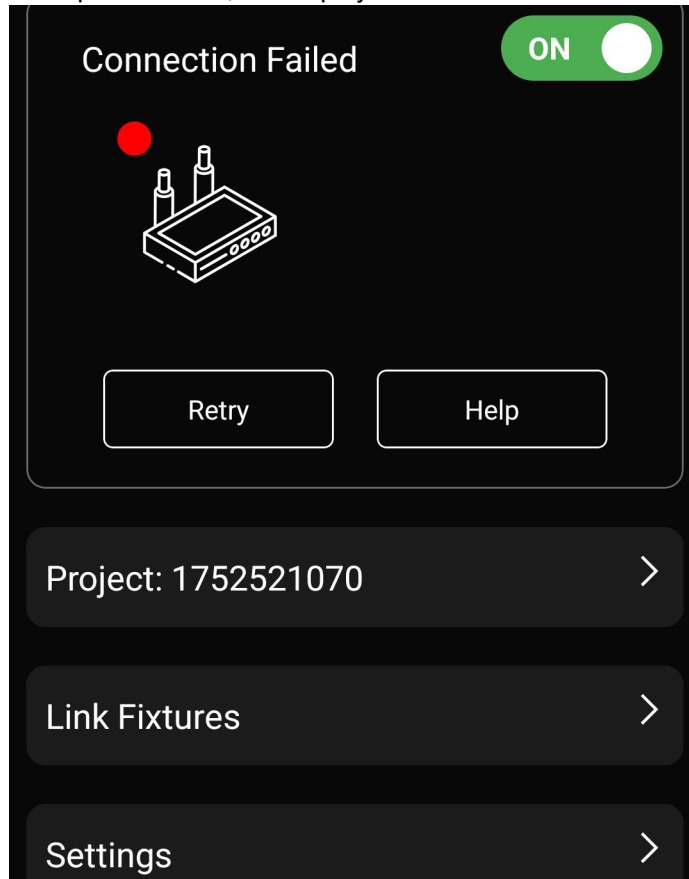

9. Once a connection is secured, the “Offline” status will change to **Connected**.

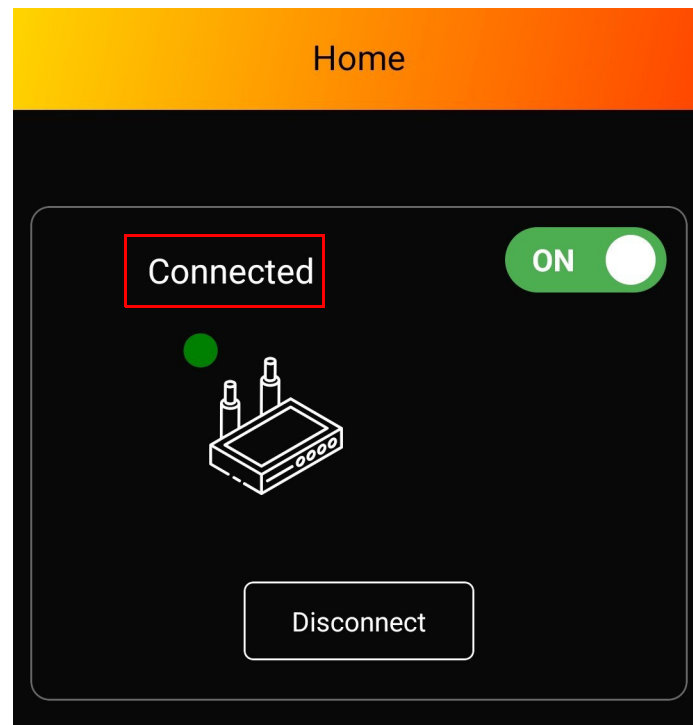

Software Update

If a software update is required on the ConnectFX, the app will show a prompt. Select the **Upgrade now via Wifi / Ethernet** option.

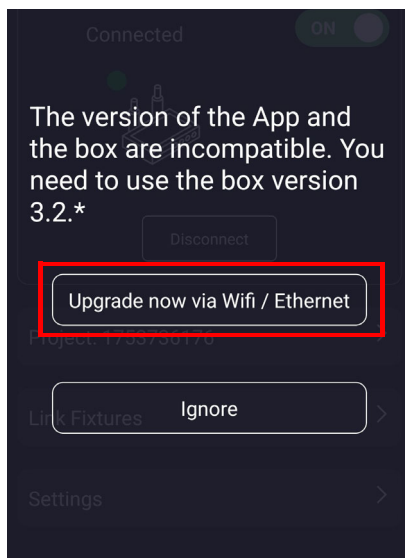

To disregard the update, select **Ignore**.

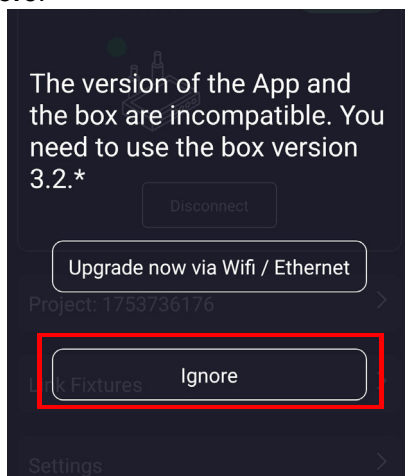

Project

The ConnectFX has a Project page where users can create new projects, export existing projects, or import projects that are already saved to the WELL CONNECT. To access the Project page:

1. Ensure the **Home** tab is selected.
2. Select **Project**: _____.

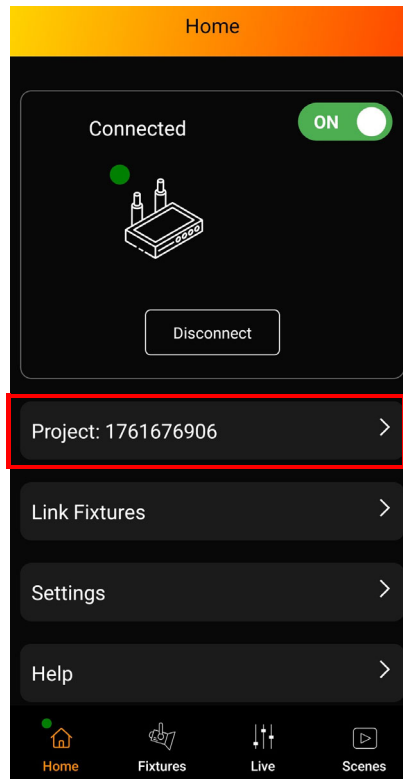

New Project

To create a new project:

1. Follow steps 1-2 in the [Project](#) section to navigate to the Project page.
2. Select **New Project**.

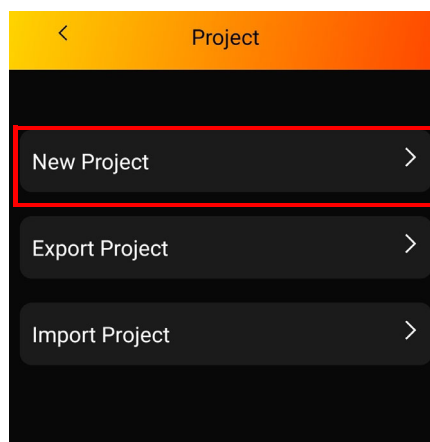

Export Project

To export a project:

1. Follow steps 1-2 in the [Project](#) section to navigate to the Project page.

2. Select **Export Project**.

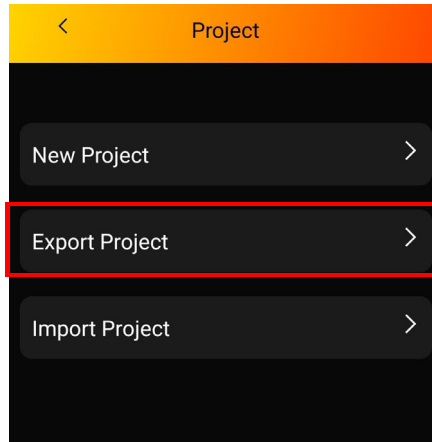

3. A pop up will appear with options within the user's mobile device.

Import Project

To import a project from the WELL CONNECT:

1. Follow steps 1-2 in the [Project](#) section to navigate to the Project page.
2. Select **Import Project**.

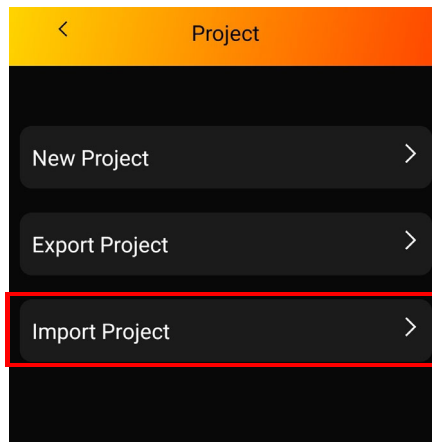

3. Select **IMPORT** from the pop-up screen. Select **CANCEL** to return to the previous screen.

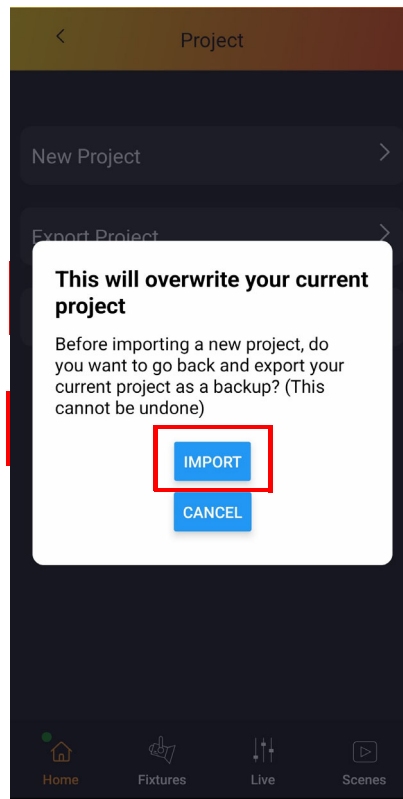

Link Fixtures

It is possible to automatically link or unlink all of the fixtures from an existing show using the ConnectFX app.

Link Fixtures

To link fixtures from an existing show:

1. Ensure the **Home** tab is selected.
2. Select **Link Fixtures**.

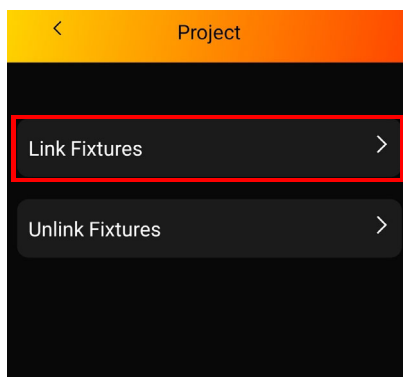

3. A Linking fixtures screen will appear until the fixtures are connected.

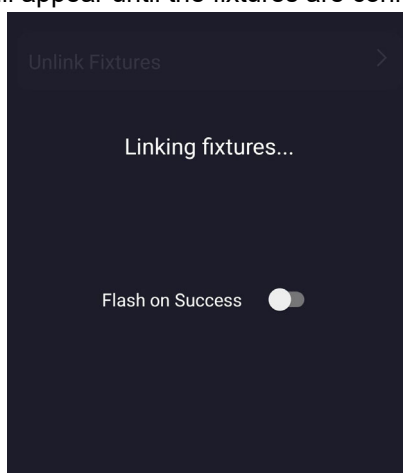

Select the **Flash on Success** button to set an indicator when link is successful.

Unlink Fixtures

To unlink fixtures from an existing show:

1. Ensure the **Home** tab is selected.
2. Select **Unlink Fixtures**.

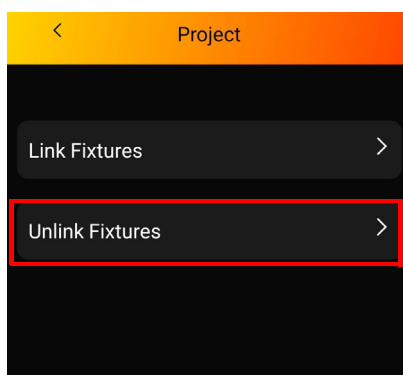

Settings

1. Ensure the **Home** tab is selected.
2. Select **Settings**.

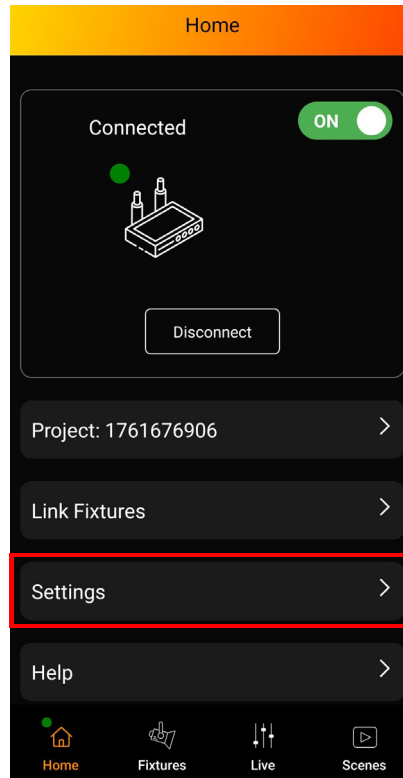

Advanced Fixture Settings

To access advanced fixture settings:

1. Follow steps 1-2 in the [Settings](#) section to navigate to the Settings page.
2. Select **Advanced Fixture Settings**. Then select **Add a custom fixture**.

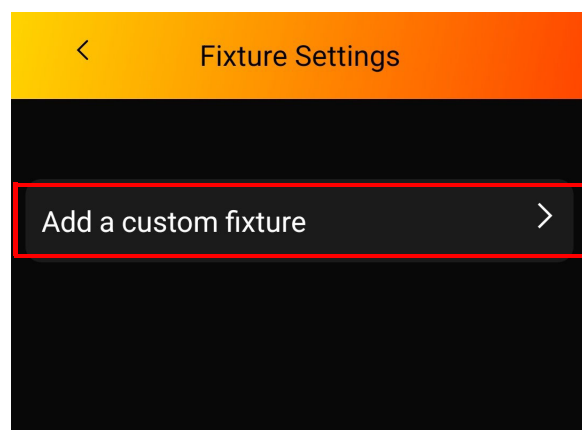
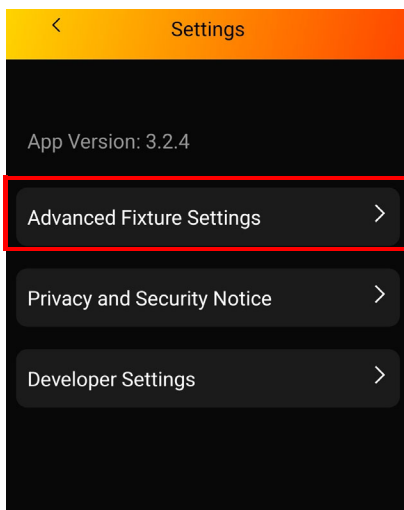

See the [Add a Custom Fixture](#) section for further instructions on how to add a custom fixture.

Privacy and Security Notice

To access Chauvet's Privacy and Security Notice:

1. Follow steps 1-2 in the [Settings](#) section to navigate to the Settings page.
2. Select **Privacy and Security Notice**.

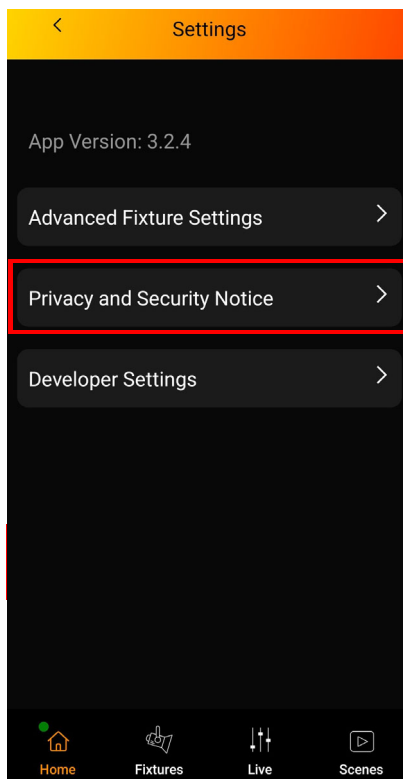

Developer Settings

This feature is reserved for Chauvet ENG access only.

Help

The Help section exists to aid users in operation of the app as well as trouble shooting. Ensure the **Home** tab is selected. To access the help page:

1. Ensure the **Home** tab is selected.
2. Select **Help**.

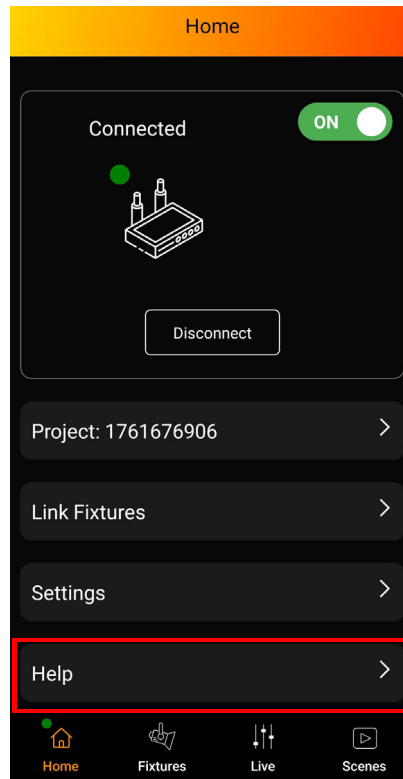

Q & A

The Questions & Answers section presents common questions and solutions. To access the Questions & Answers section of the ConnectFX:

1. Follow steps 1-2 in the [Help](#) section to navigate to the Help page. Select **Q & A**.

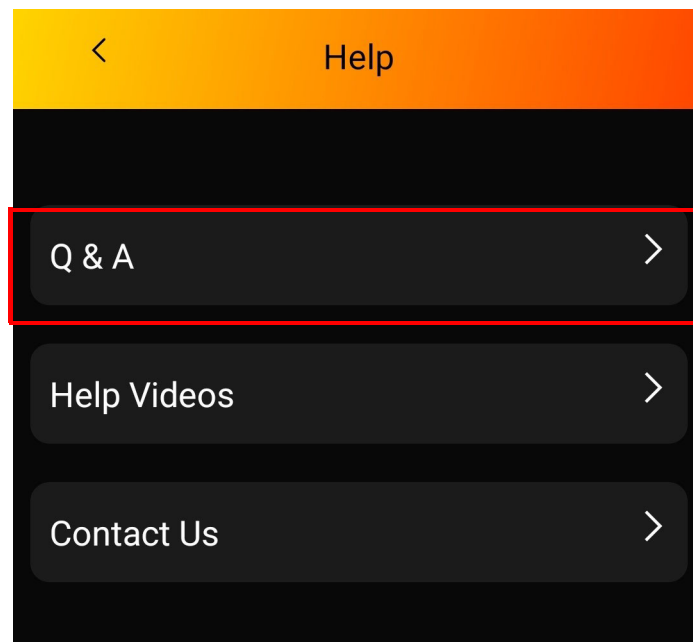

2. Select the desired question to generate an answer. Select again to collapse.

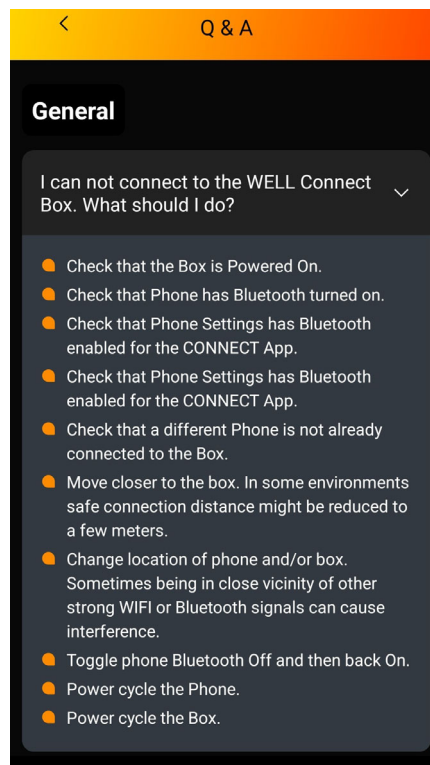
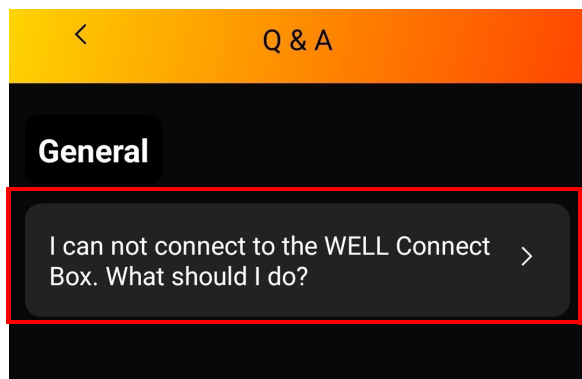

Help Videos

The Help Videos section provides a quick reference for users to learn helpful tips when navigating the app. To access the Help Videos section in the ConnectFX app:

1. Follow steps 1-2 in the [Help](#) section to navigate to the Help page.
2. Select **Help Videos**.

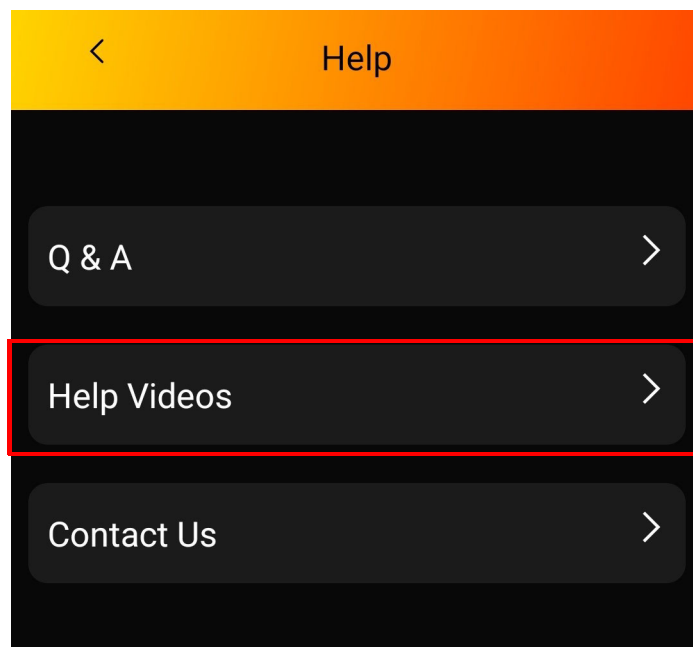

3. Scroll up or down to locate the desired video, then select to watch.

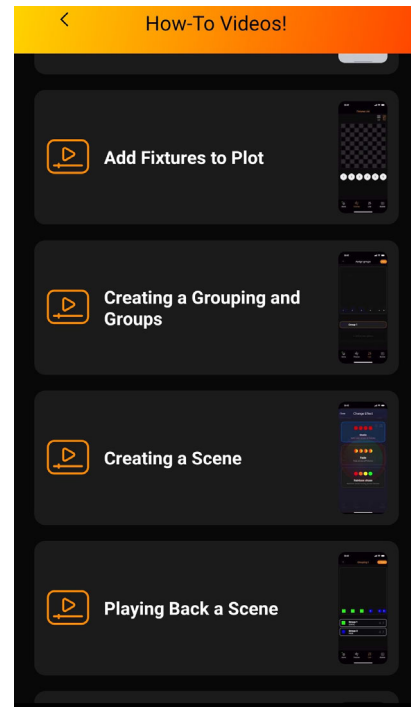
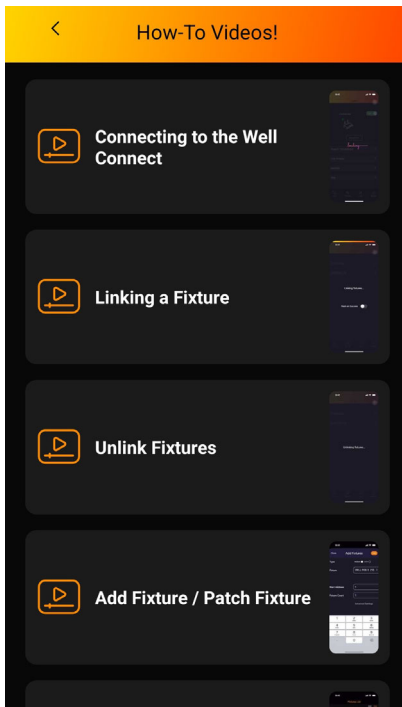

Contact Us

The Contact Us section displays all of Chauvet's contact information. To access the Contact Us page:

1. Follow steps 1-2 in the [Help](#) section to navigate to the Help page.
2. Select **Contact Us**.

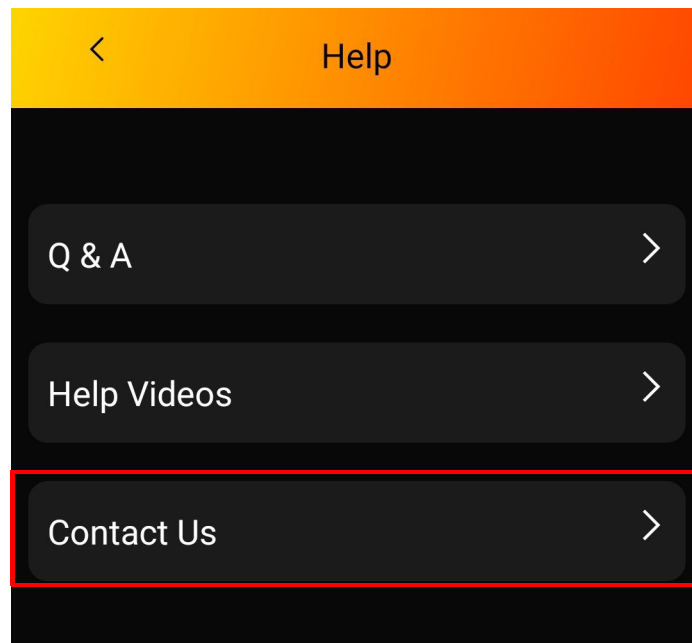

3. Scroll up and down to view Contact Us information. To call or email an office, select the desired office contact info.

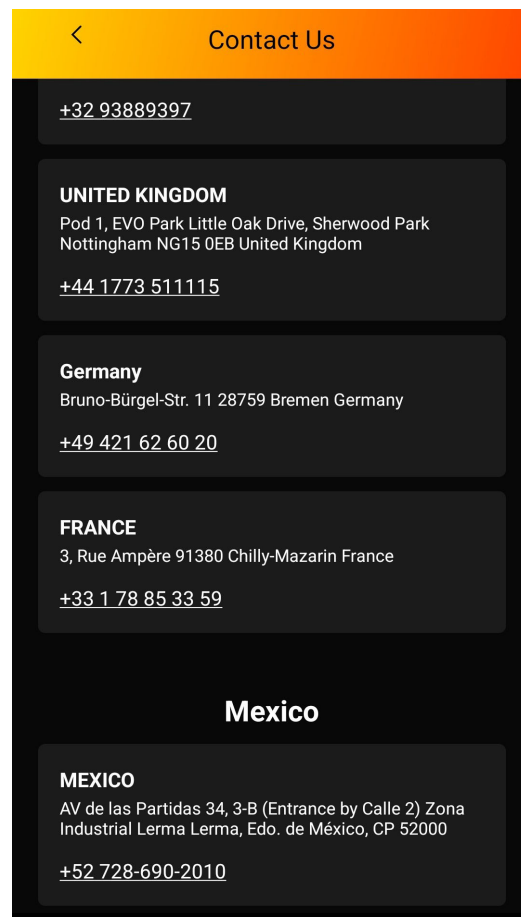
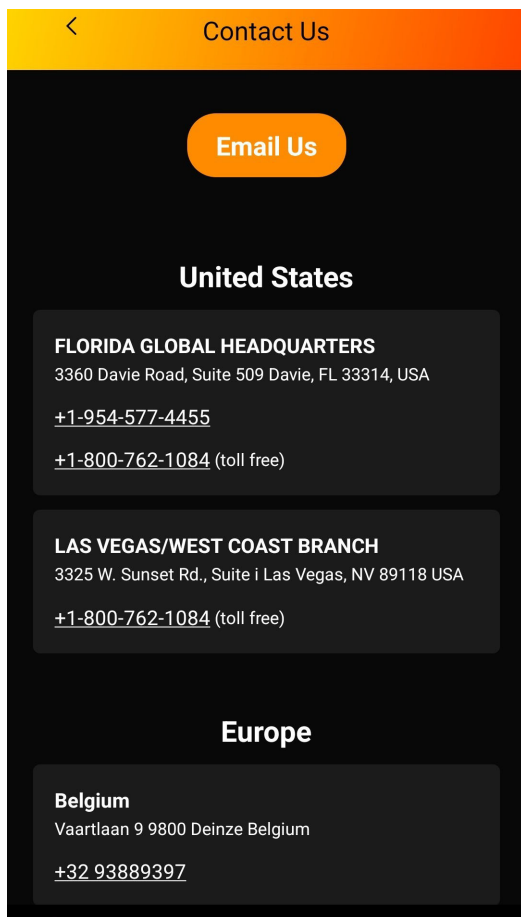

Fixtures

The ConnectFX allows users to add multiple patched fixtures and plot them within the app.

List

Add Fixtures

Before plotting fixtures, it is first necessary to add fixtures to list. To add fixtures to the list:

1. Select the **Fixtures** tab in the Navigation Bar.

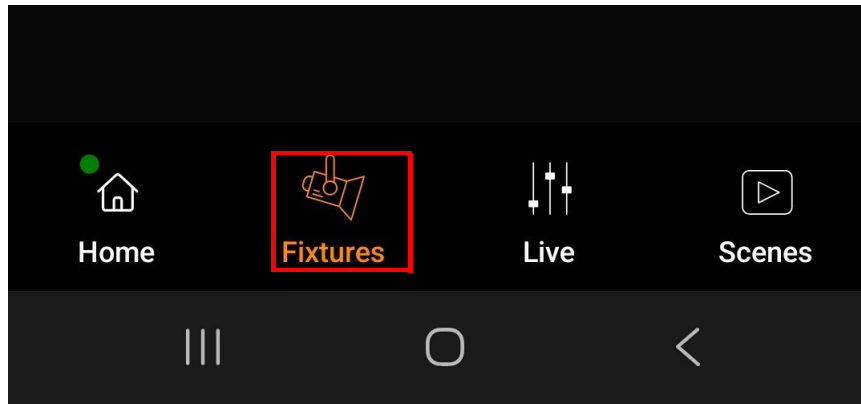

2. Ensure that the **List** page is selected and select **Add Fixtures** to trigger a pop up screen.

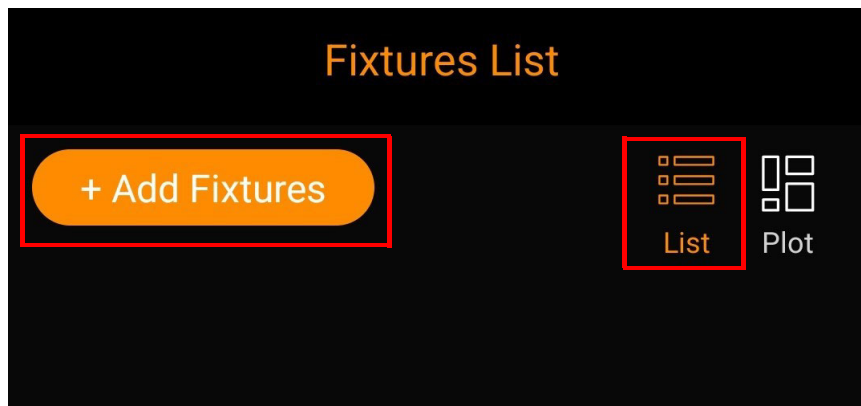

3. On the Add Fixtures pop-up screen, users will be prompted to enter fixture details before adding the fixture. To enter fixture details:
 - a. Next to **Type**, select a connection from either **WDMX** or **D-Fi**.

- b. Select the drop down menu next to **Fixture** to select a desired fixture.



If a desired fixture is not included in the Select Fixture Type list, it is possible to select a generic preset from the list.

- c. With the desired fixture or preset selected, select **Done** or **Cancel** to return to the previous pop-up screen.

- d. Set the desired starting address and fixture count by selecting the each box and typing the desired address/count by using the keypad. Once complete, select **Done**.

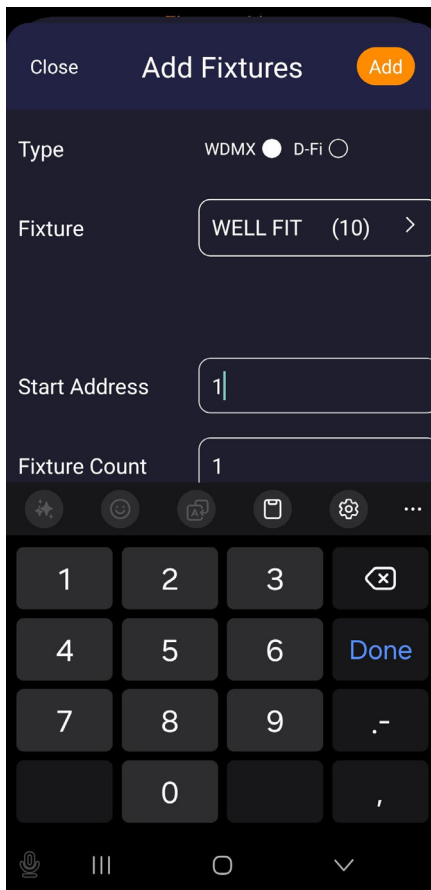
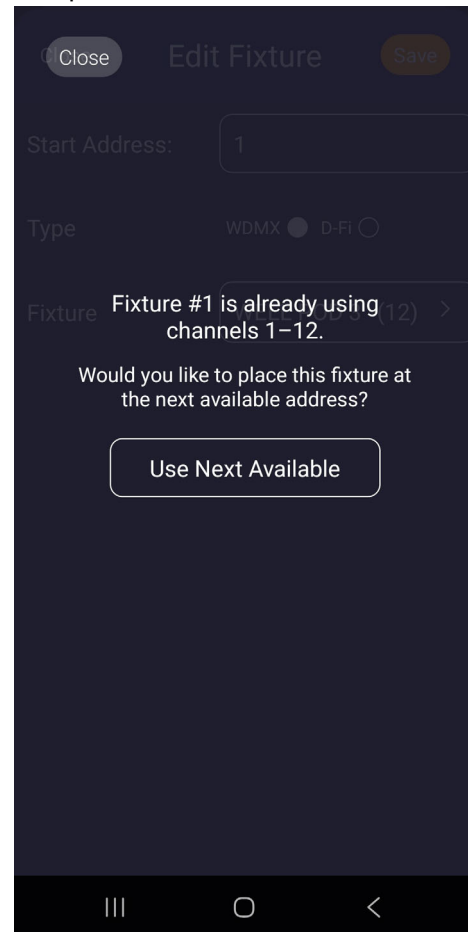
- The app will instruct users to place the fixture in a target personality.
- In this instance, the app is instructs users to set their WELL POD 3 to its 12 Channel personality (12ch). If an existing fixture has already been added, the app will suggest a different address range from that fixture.

- e. Once completed, select **Add** to add the fixture to the list.
4. Once fixtures have been added to the list, they will appear on the Fixture List page.

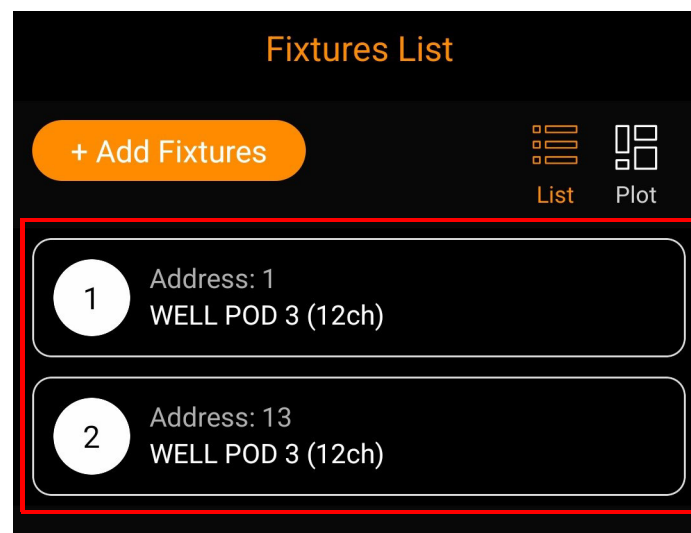

Add a Custom Fixture

If the fixture to be added is not included in the app, users may add a custom fixture. To add a custom fixture:

1. Follow steps 1-2 from the [Add Fixtures](#) section to navigate to the Add Fixtures pop-up.
2. Select **Advanced Settings**.

3. In the Fixture Settings page, select **Add a custom fixture**.

- Adjust the the settings on the Add New Profile page and select **Add**.

Close
Add New Profile
Add

Name

Type
☒ ON

Channels

R Channel

G Channel

B Channel

White Channel

Amber Channel

UV Channel

Close
Add New Profile
Add

B Channel

White Channel

Amber Channel

UV Channel

Dimmer Location

Strobe Location

Edit Fixtures

Once fixtures have been added to the Fixtures List page, users may still edit them. To edit fixtures that have been saved to the Fixtures List page:

1. Select one of the fixtures from the list.

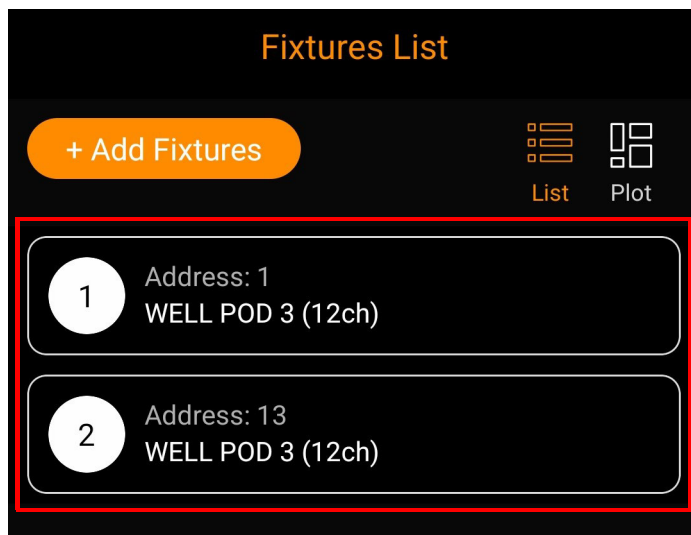

2. Once the fixture has been selected, an Edit Fixtures pop-up will appear. Adjust the desired values and select **Save**.

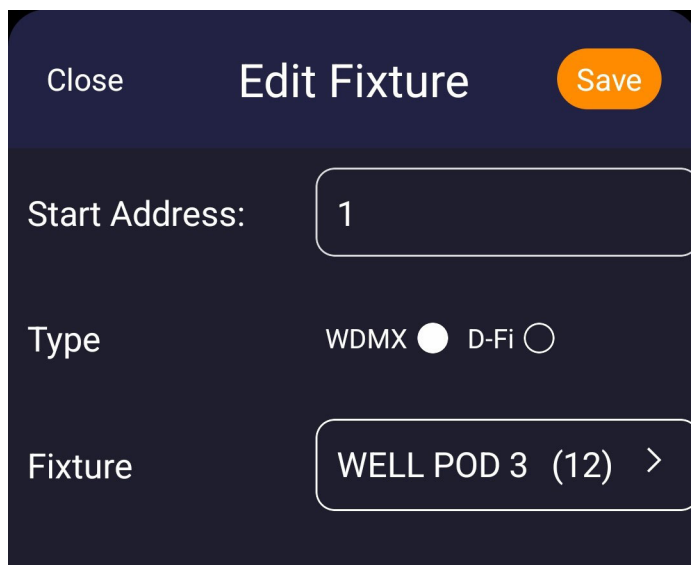

Plot

Placing Fixtures

To plot the fixtures:

1. Select the **Fixtures** tab in the Navigation Bar.

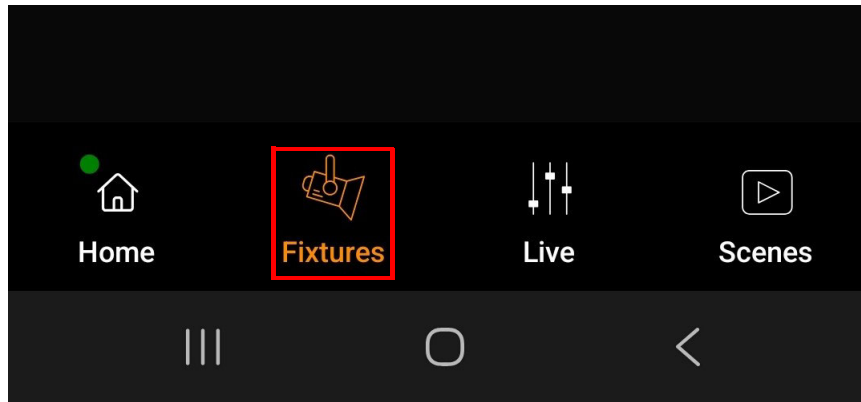

2. Ensure that the **Plot** page is selected.

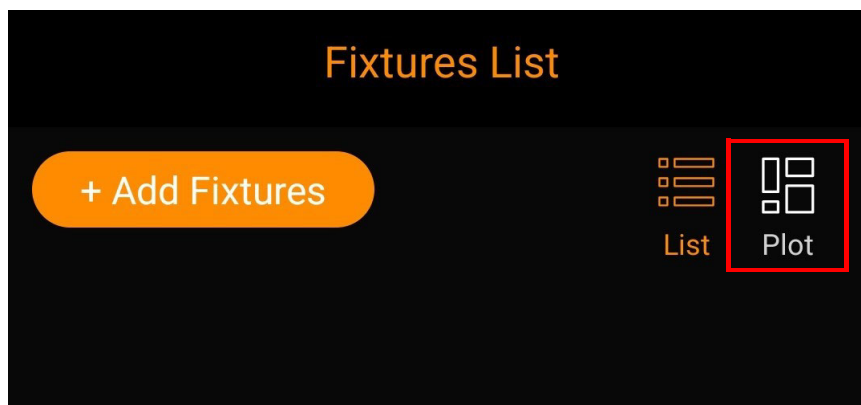

3. A fixture number icon will appear below the bottom center of the plot. If there are multiple fixtures on the list, multiple icons will appear beneath the plot.

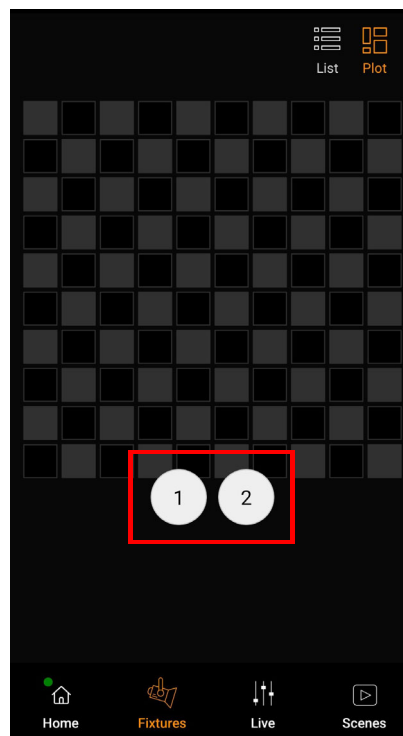
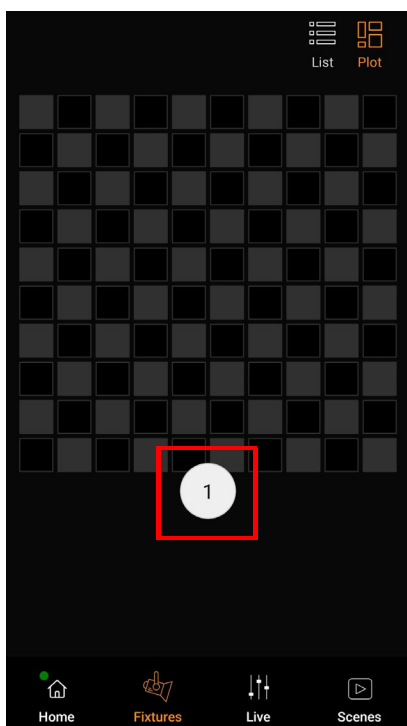

4. To add the fixture(s) to the plot, press the fixture icon(s) desired.

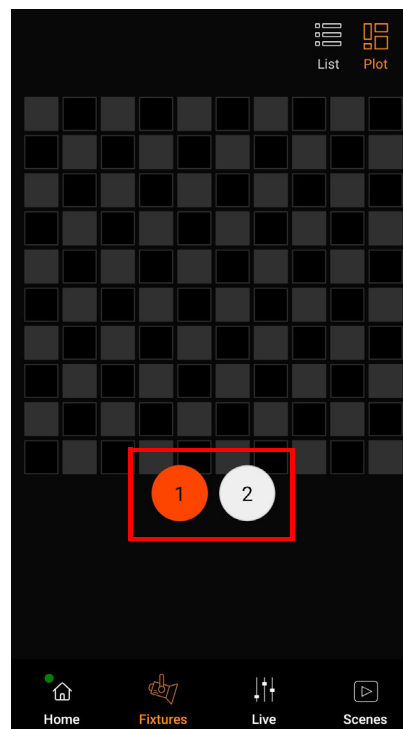
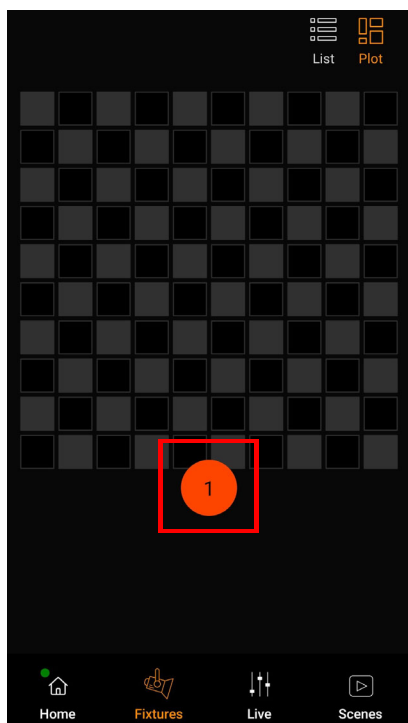

Once the fixture number has been selected, the fixture output will turn on and the icon will appear red.

5. Once the desired fixture is selected, select a point on the plot to place the fixture.

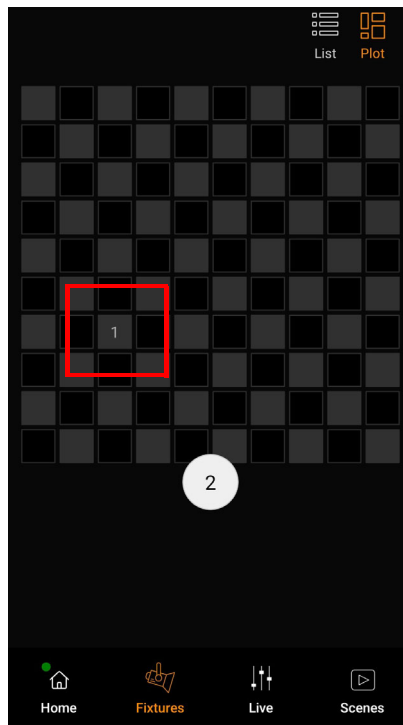

Removing Fixtures

Once fixtures have been plotted, it is possible for users to remove them from the plot. To remove a fixture from the plot:

1. Select the plotted fixture and press **Remove Position** to remove the fixture from the plot.

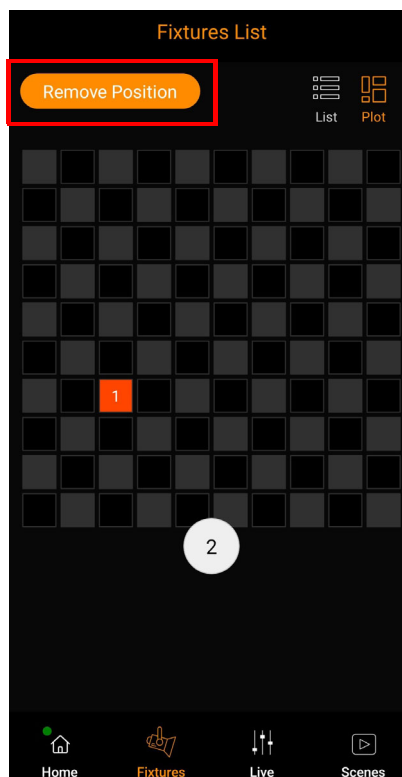

3. Operation

Live

It is possible to control and edit all fixtures at once or group fixtures via the ConnectFX app. Follow the instructions below to control and edit either all or grouped fixtures.

All Fixtures

On the All Fixtures page, it is possible to edit effects, adjust the intensity and strobe output, and save scenes for later playback on all fixtures. To access the All Fixtures page:

1. Select the **Live** tab in the navigation bar.

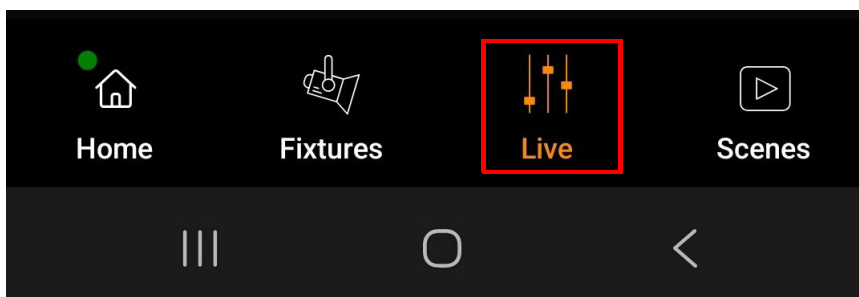

2. On the Live homepage, select **All Fixtures** to access the All Fixtures page.

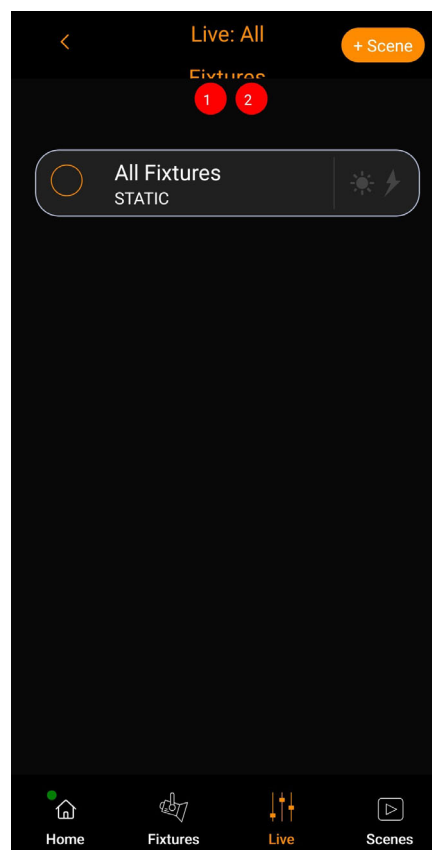
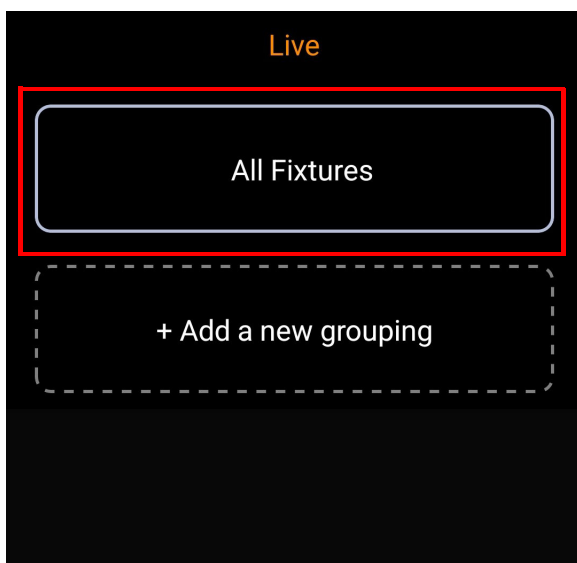

- All saved fixtures will appear at the top of the page in a numbered icon
- The numbered icon will correspond to the fixture's output.
- If the fixture(s) are strobing, a thin circle will appear around each fixture icon.

Operation

Effects

The effects page allows users access to effect types. Once an effect type has been selected, further features may be edited.

Effect Type

To toggle effects:

1. Follow steps 1-2 under [All Fixtures](#) to navigate to the All Fixtures page.
2. Select All Fixtures button to access the Effects page.

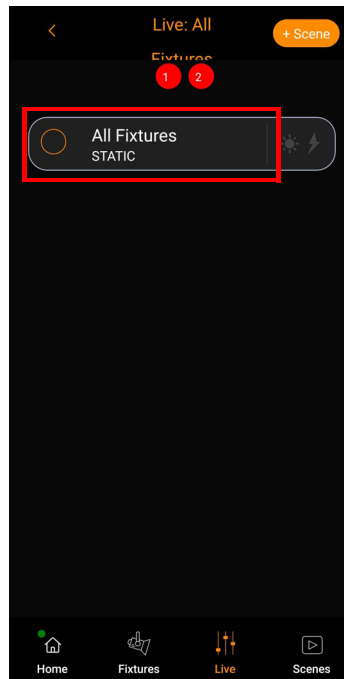

3. On the effects page, select **Effect Type**: to adjust different effects, from **Static**, **Fade**, or **Rainbow chase**. To cancel changes, select **Close**.

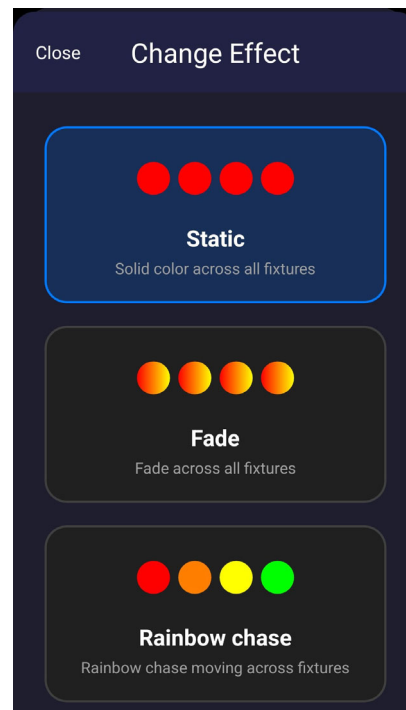
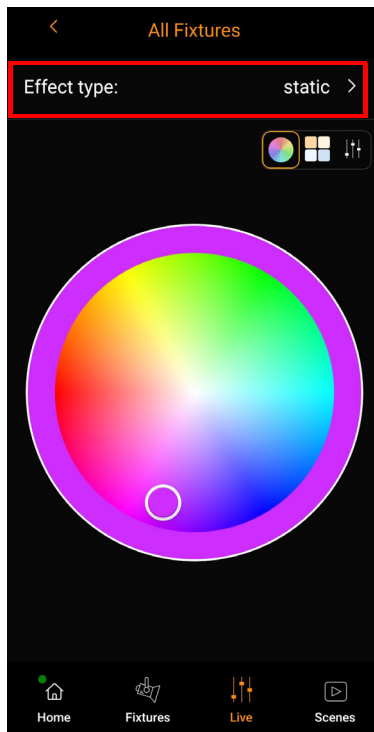

Static

The static option presents a solid color across all fixtures. If the static effect is selected, users will have access to a color picker, color temperatures, and color mixer. Follow the instructions below to access each of these options.

- a. To use the color picker, select the color picker icon on the Effects Panel. Then select the desired color on the color picker.



- b. To set a color temperature, select the color temperature icon on the Effects Panel. Then select the desired color temperature from the menu below.

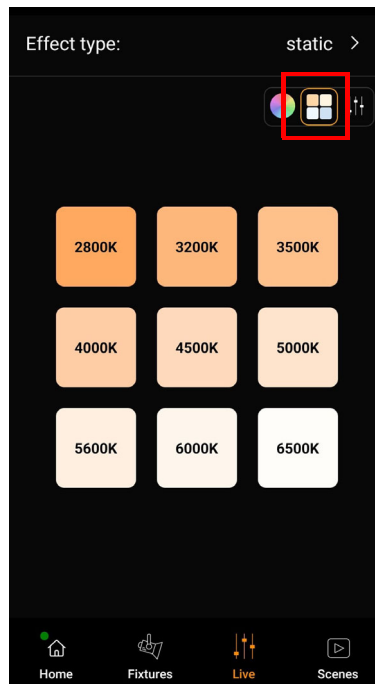

- c. To adjust the color mixer, select the color mixer icon on the Effects Panel. Then use the sliders to adjust the values for each color.

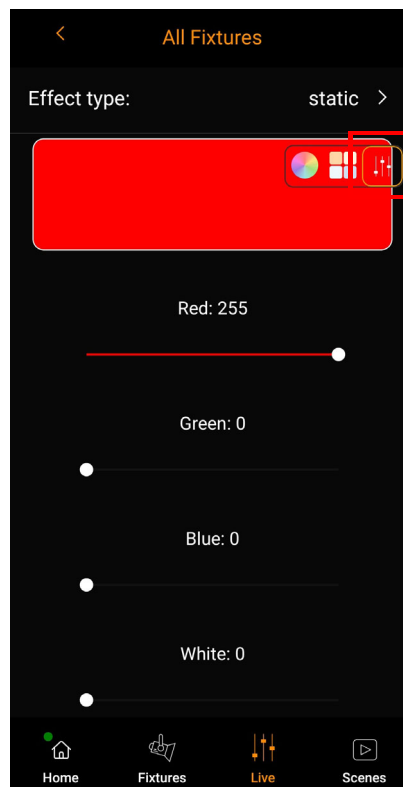

The color palette will change to reflect any adjustments made with the sliders.

Fade

The fade option presents a fade across all fixtures. The fade option permits users to adjust the step and fade in time, change fade colors, and add steps. To access each of these options:

- a. To adjust the Step time or Fade in time, select the box next to **Step Time(s)** or **Fade In (s)**. Then enter the desired number of seconds into the number pad and select **Done**.

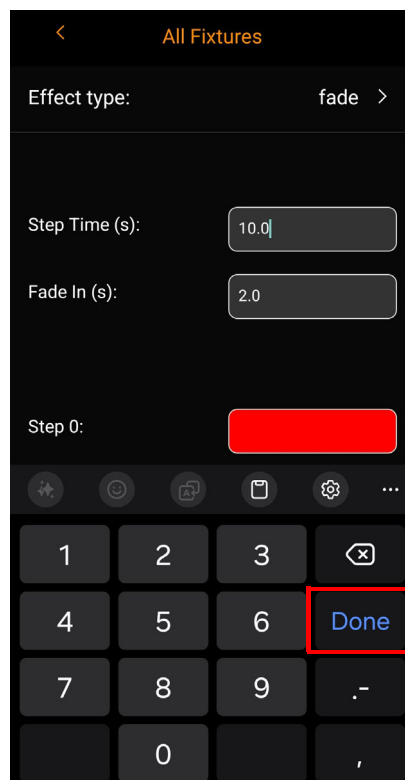

- b. To program a step, select **Step 0**. Then use the color picker in the pop up to select the desired color. Repeat with the following steps as desired.

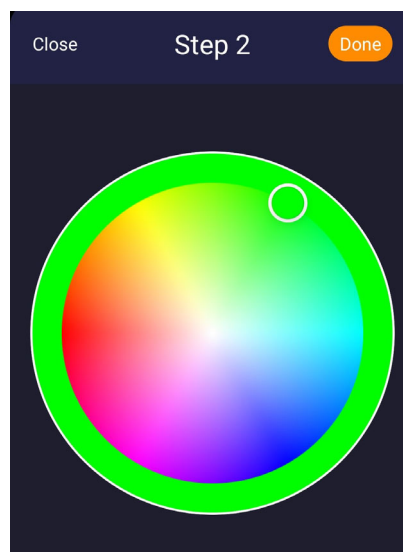
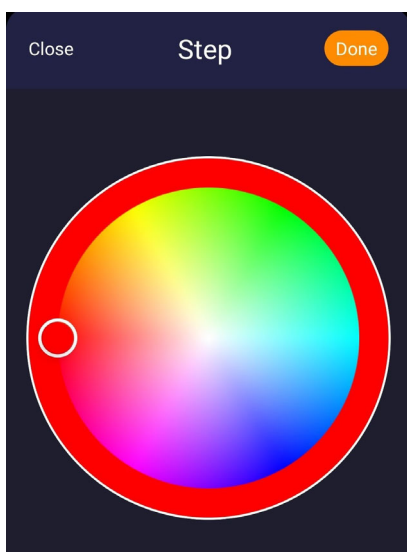

- c. To add a step, select **Add Step**.

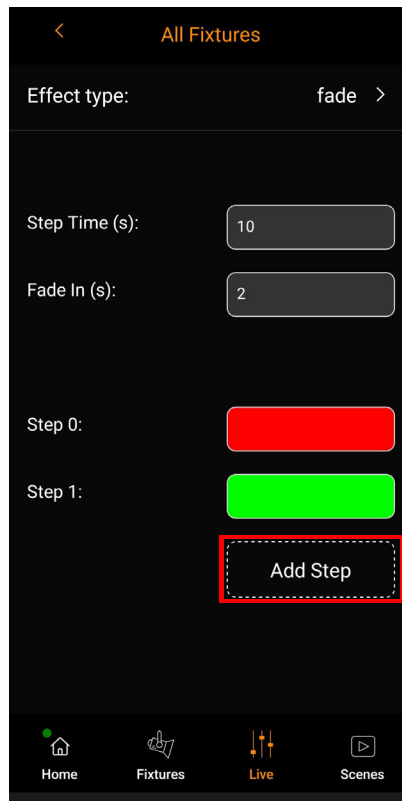

- d. Once the desired fade effects have been selected, select **Regenerate Effect**.

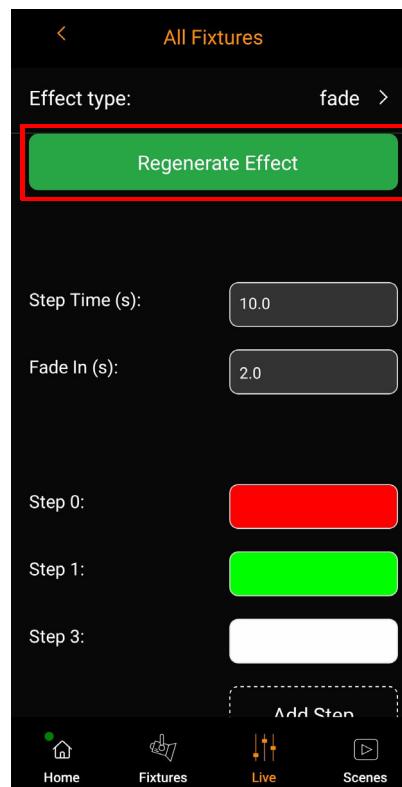

Rainbow Chase

The rainbow chase effect presents a rainbow chase moving across all fixtures.

- a. To adjust the Step time or Fade in time, select the box next to **Step Time(s)** or **Fade In (s)**. Then enter the desired number of seconds into the number pad and select **Done**.

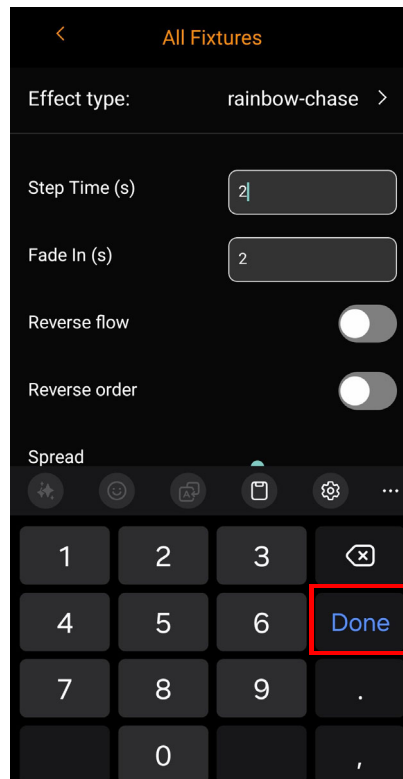
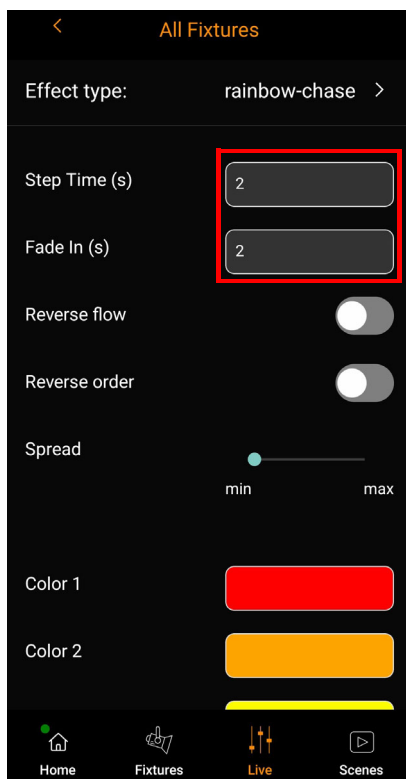

- b. To reverse the order of the paired fixtures output, select **Reverse flow**.

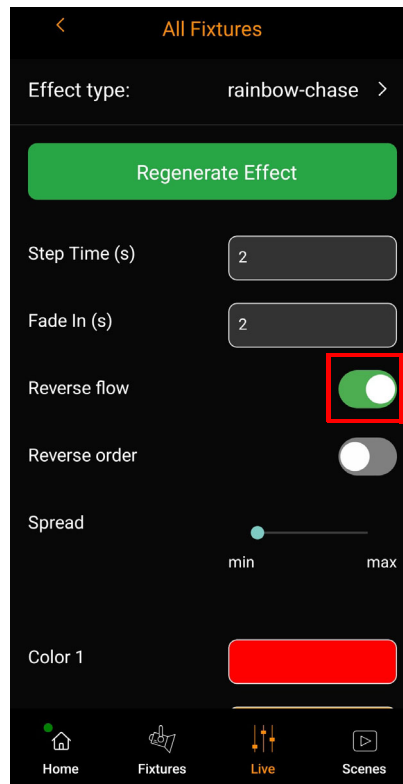

- c. To reverse the in which the custom colors are appear in the rainbow effect, select **Reverse order**.

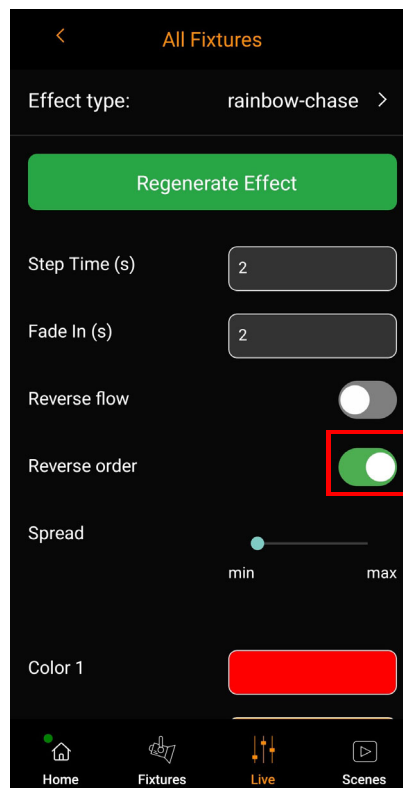

- d. To maximize the area of the output, adjust the **Spread** slider.

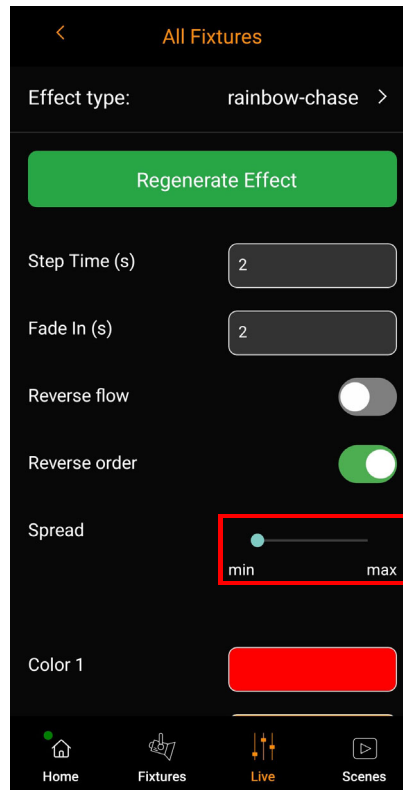

Moving the slider towards the minimum will reduce the spread of the output while moving the slider towards the maximum will increase the spread of the output.

Intensity and Strobe

To edit the intensity and/or strobe on all fixtures:

1. Follow steps 1-2 under [All Fixtures](#) to navigate to the All Fixtures page.
2. Select Intensity and Strobe icons to access the Intensity & Strobe page.

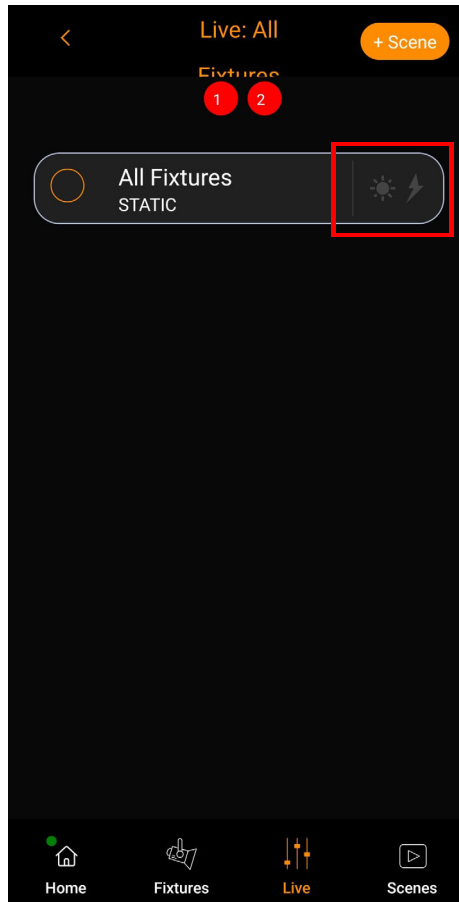

3. Use the **FX Intensity** and **FX Strobe** sliders to adjust the intensity and strobe values.

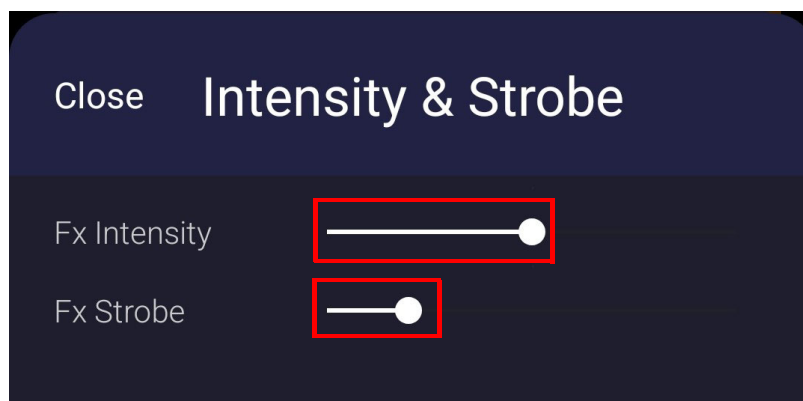

4. Select **Close** to return to the previous page.

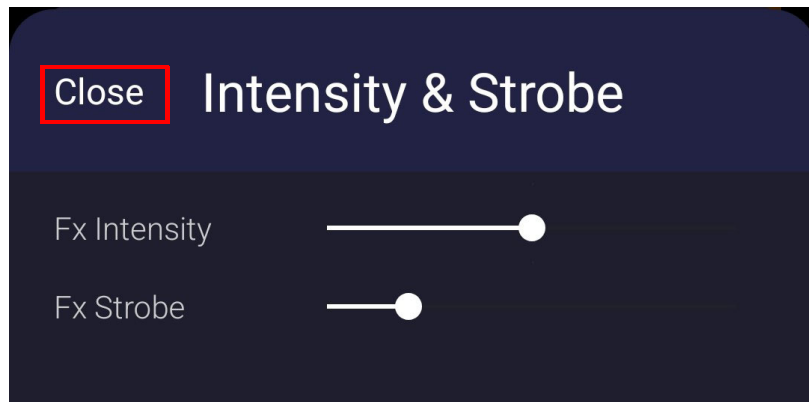

Add a New Grouping

It is possible to group several fixtures together using the ConnectFX. To add a new grouping using the ConnectFX:

1. Select the **Live** tab in the navigation bar.

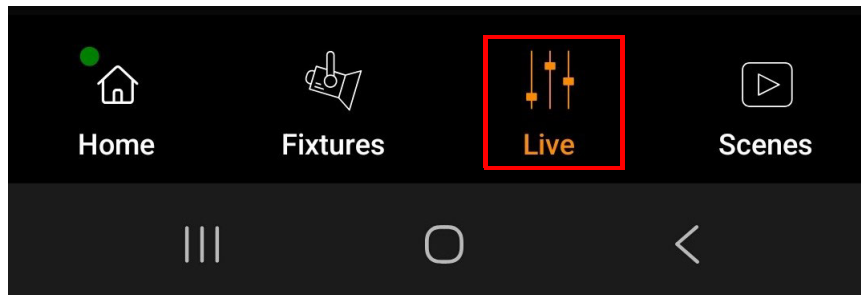

2. Select **Add a new grouping**.

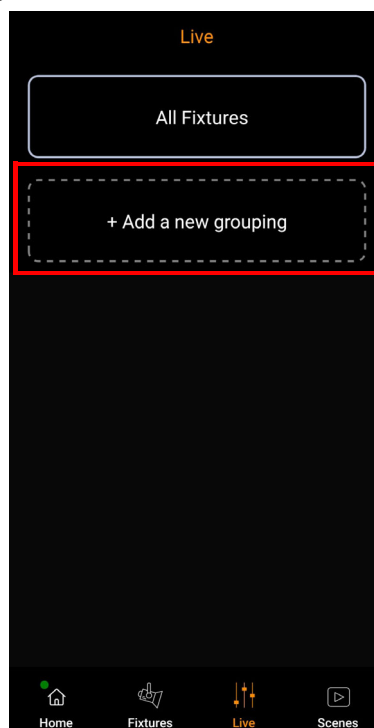

3. Edit the name of the grouping and select **Create**.

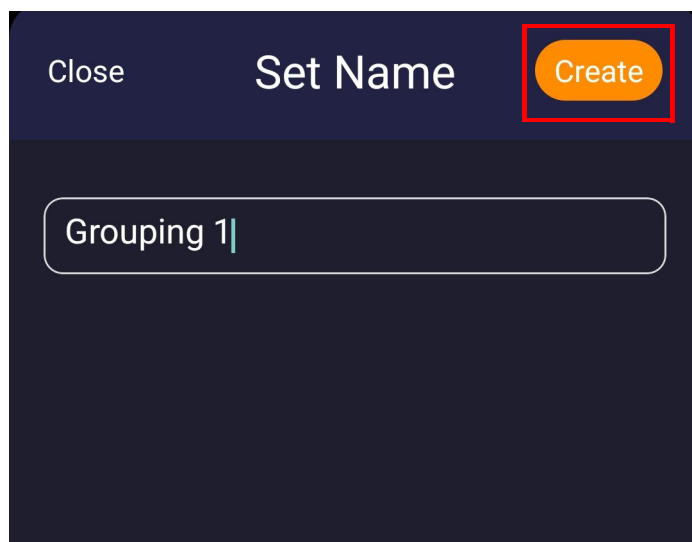

Create a Group

Once the grouping has been created, it is possible to create groups within the grouping. To assign groups within a grouping:

1. Select **add a new group**.

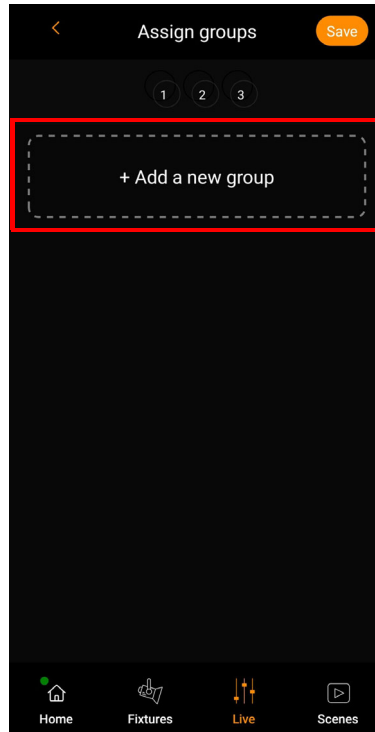

2. Edit the name of the group and select **Create**.

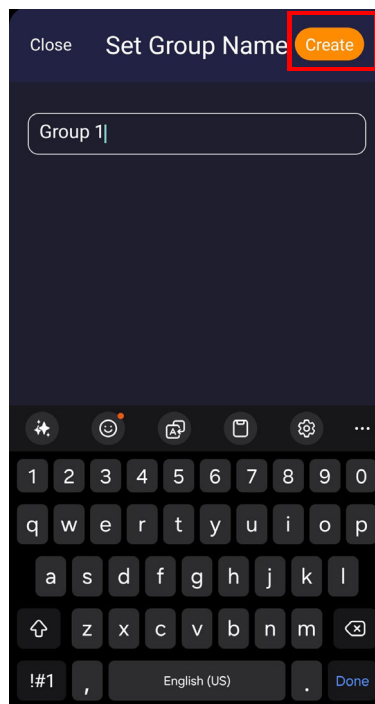

- Once the first group is created, it is possible to assign one or more fixture(s) to a group. Select the desired group followed by the desired fixture.

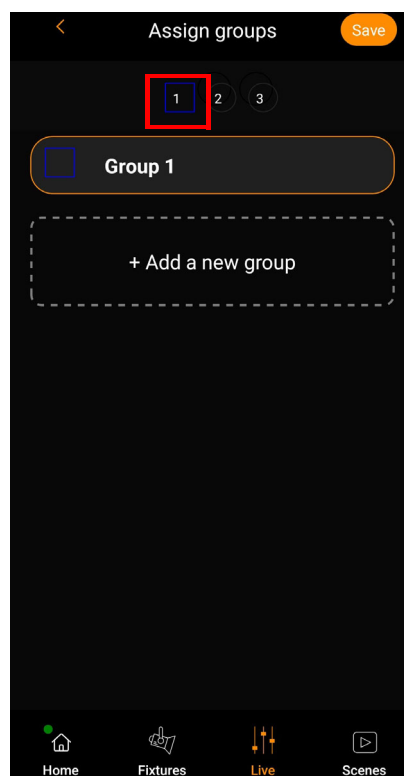
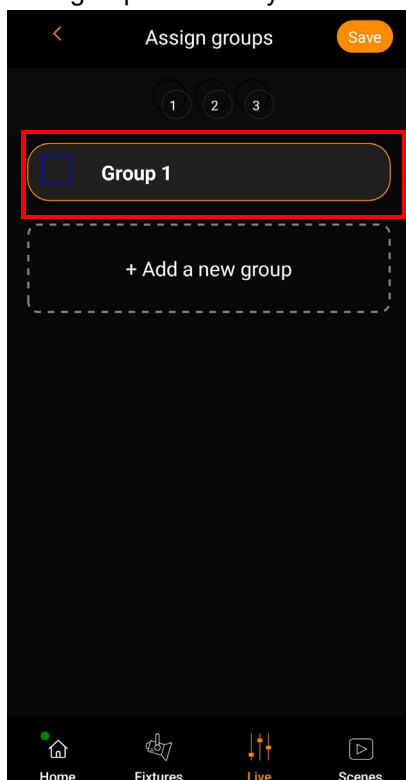

Groups will be assigned icons with different colors and shapes. Once a fixture is assigned, it will share the same icon/shape as the group.

- To add more groups to the existing grouping, select **Add a new group** and repeat step 3. Select **Save** to save the entire grouping.

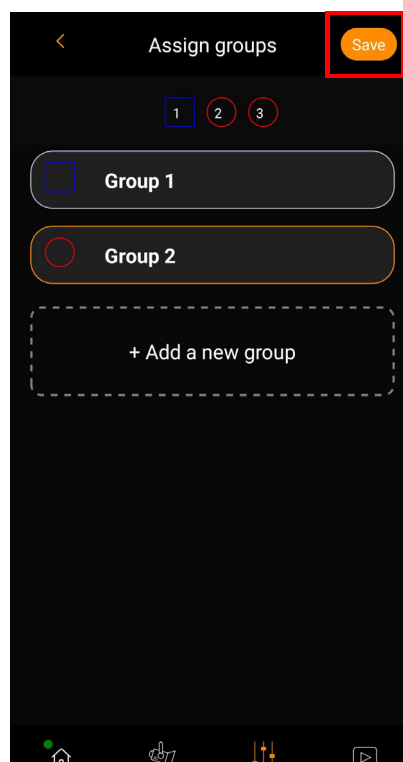
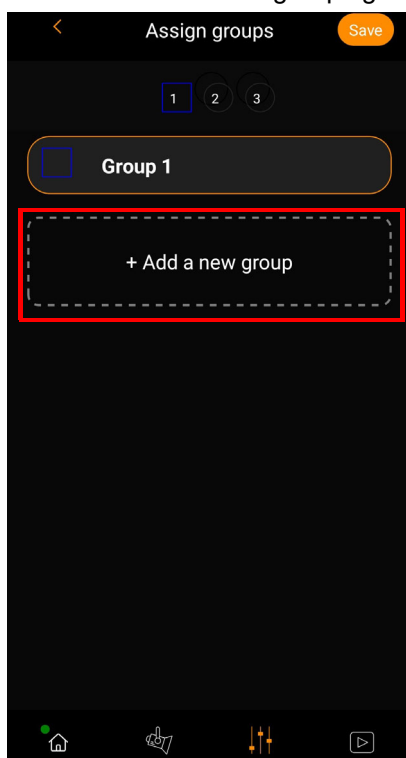

Edit Grouping

It is possible to edit saved groupings. To edit a saved grouping:

1. Press and hold the grouping to edit.

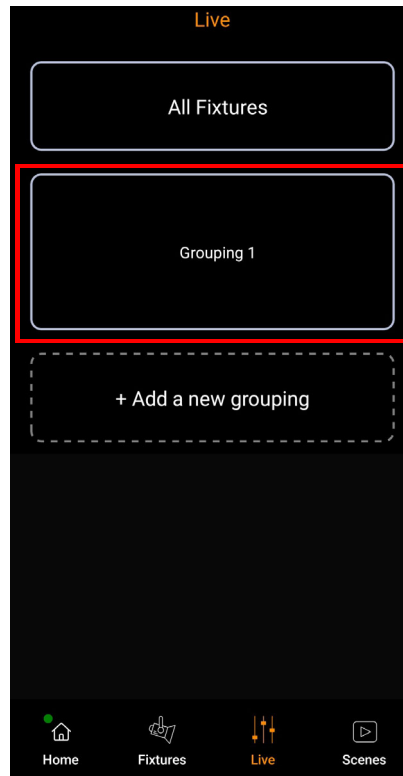

2. Select **Edit Grouping**.

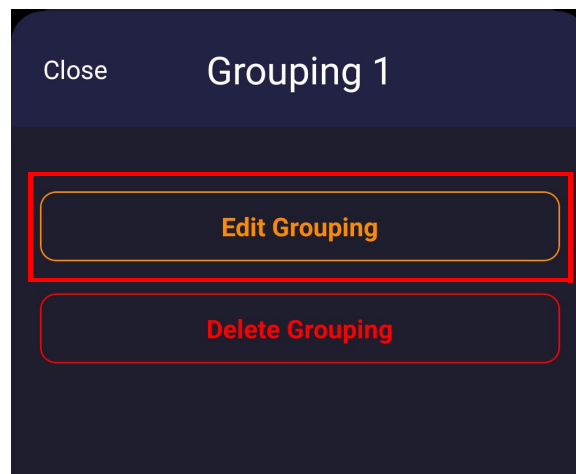

3. Follow instructions under [Create a Group](#) to edit the existing group.

Delete Grouping

It is also possible to delete saved groupings. To delete a saved grouping:

1. Press and hold the grouping to edit.

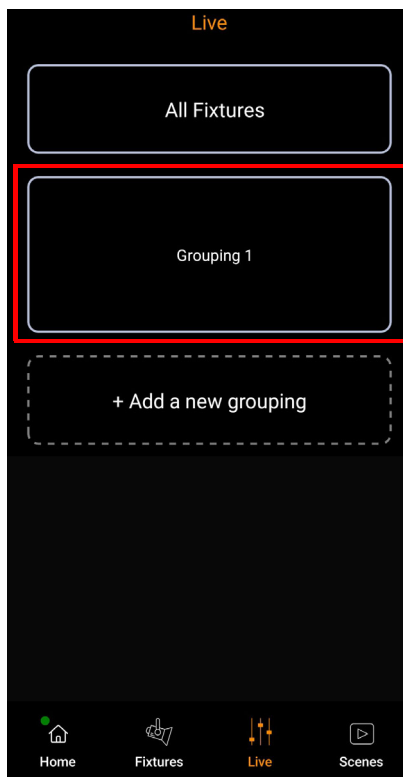

2. Select **Delete Grouping**.

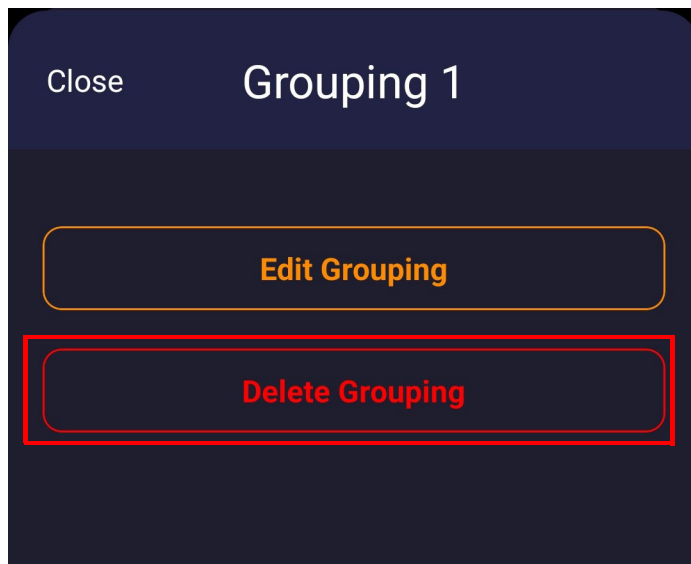

Edit Group Effects

Once a grouping has been saved, the app allows users to edit a group's effects. To edit a group's effects:

1. Select the desired grouping from the Live homepage.

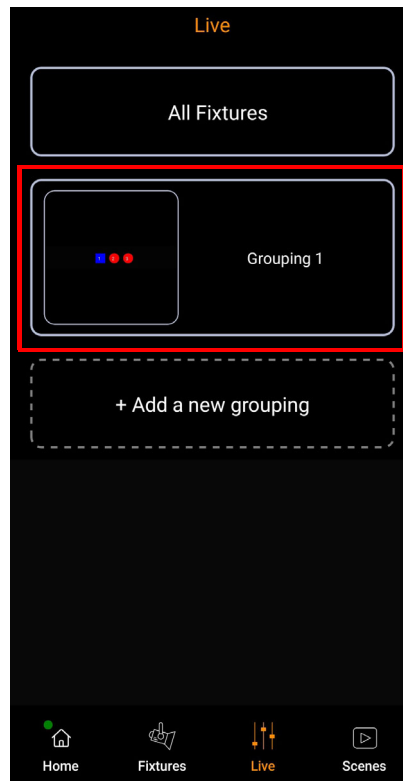

2. Select the desired group from the grouping page.

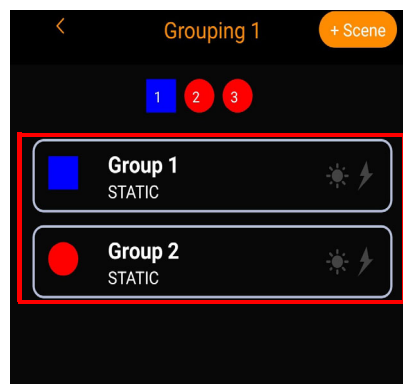

3. Once the desired group has been selected, follow the instructions from the [Effects](#) section to edit effects.

Add a Scene

The app allows users to create and save scenes for later playback. To create a custom scene:

1. Decide whether the scene will apply to either all fixtures or a specific grouping and select the appropriate option.

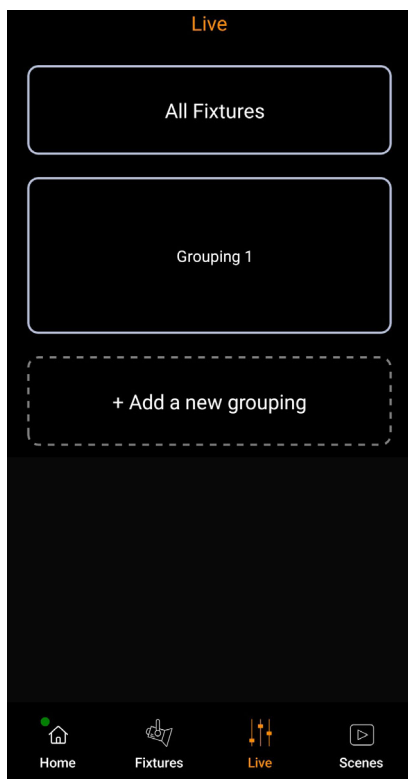

2. Select the **+Scene** button at the top right of the display.

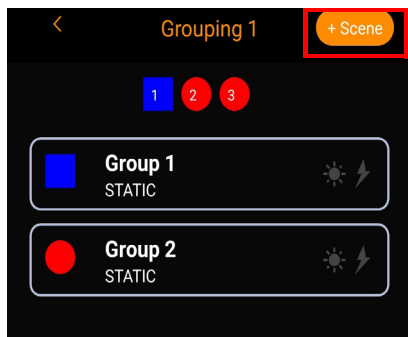

3. Name the scene by entering the desired text into the **Scene Name** text box and select **Save** when complete.

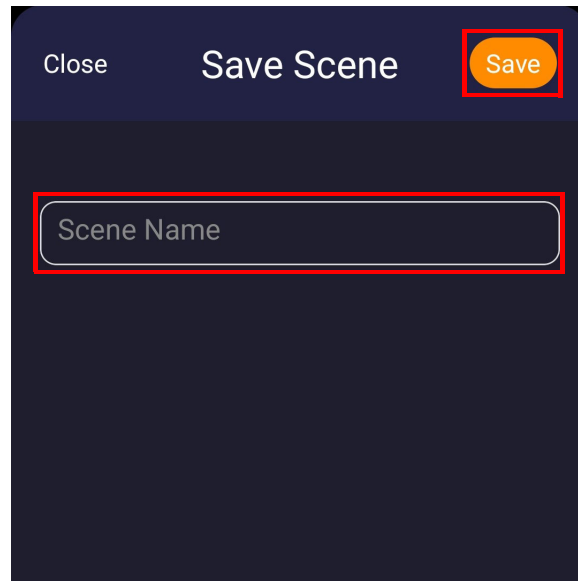

4. Once the scene has been saved, a pop up activate instructing the user to go to use the **Scenes** tab to view and activate scenes. Select **OK** to exit the pop up.

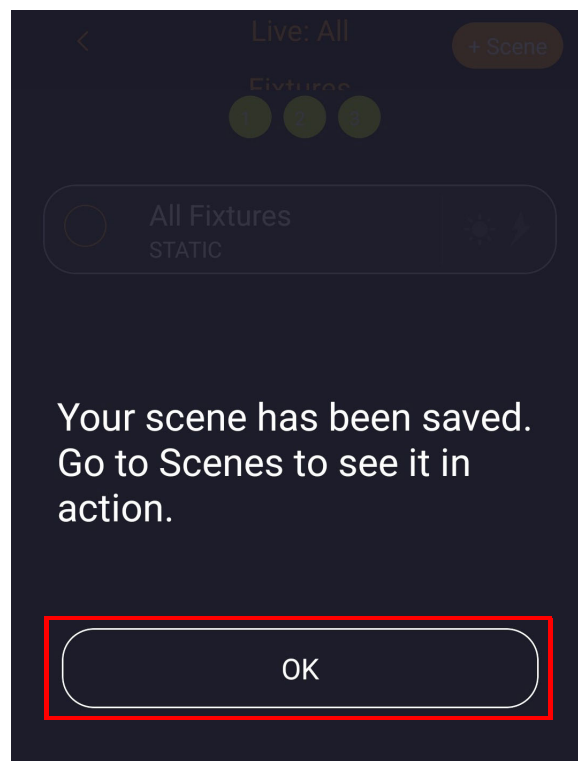

Scenes

It is possible to view, edit, and activate saved scenes in the **Scenes** tab.

To access the Scenes main page:

1. Select the **Scenes** tab in the navigation bar.



Master Settings

In the Scenes tab, users may opt to adjust the settings of saved scenes or To adjust the settings of all saved scenes:

1. Navigate to the Scenes main page.
2. Locate the master settings at the top of the main page.

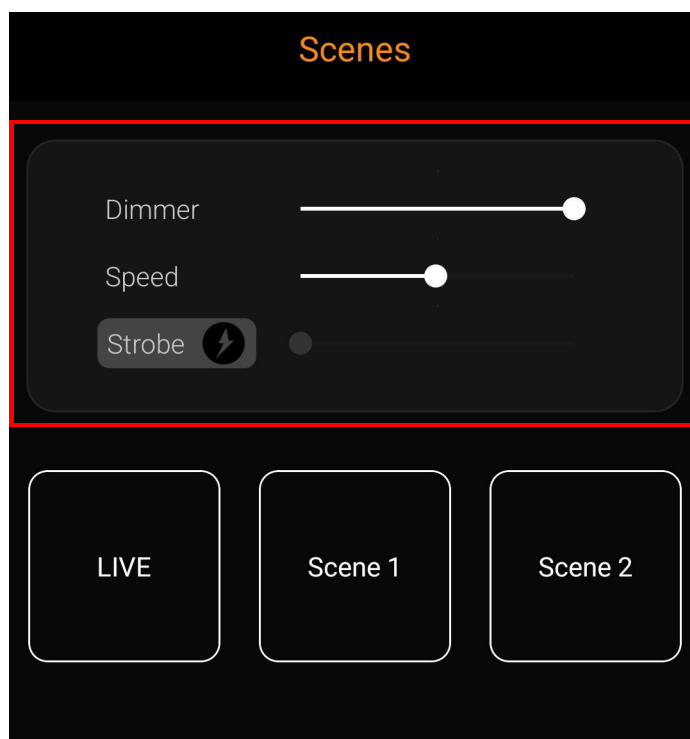

3. Adjust the dimmer and speed by moving the respective sliders.

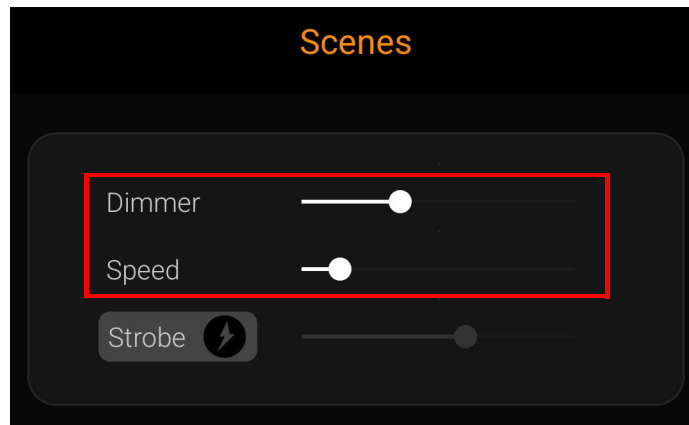

4. To adjust the Strobe value on all scenes, Press the strobe button and move the slider.

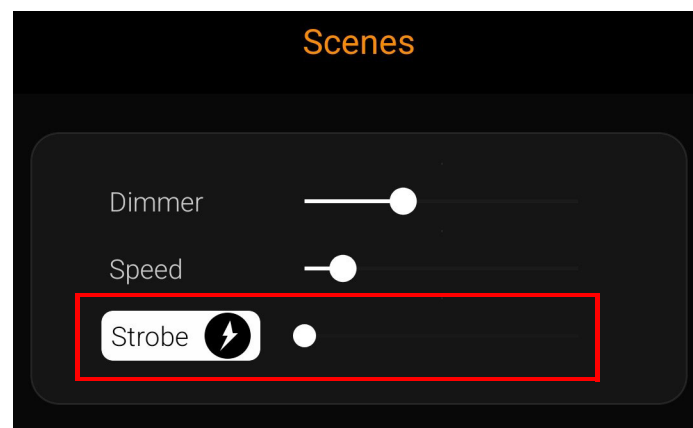

Press the Strobe button to toggle strobe function on and off.

Scene Settings

It is also possible to adjust the settings of each individual scene. On the Scene Settings page, users can edit effects, make a copy of the scene, and delete the scene. To access the Scene Settings page:

1. Navigate to the Scenes main page.
2. Press and hold on the desired Scene button to trigger the scene's settings page.

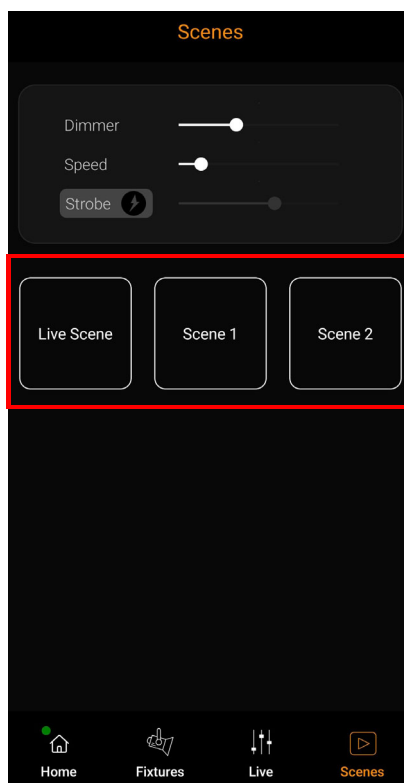

Edit Scene Effects

To edit the Scene's effects:

1. Follow steps 1-2 from the [Scene Settings](#) section.
2. Select the edit icon.
3. A prompt will appear asking if the user would like to edit the scene into the live view. Select **Yes** to edit the scene.

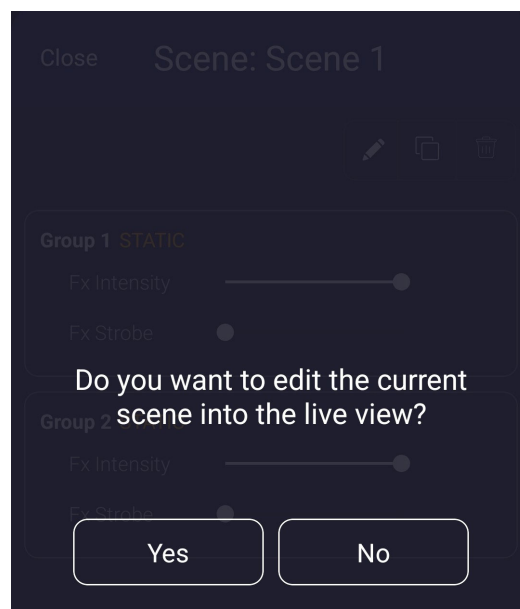
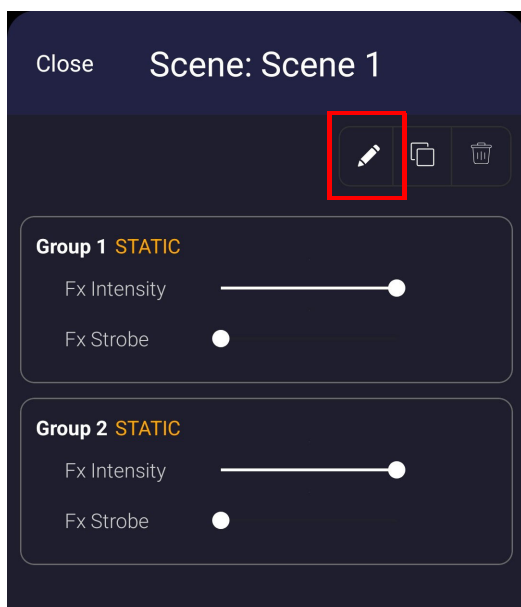

4. On the Editing Scene page, select a group and follow the instructions from the [Effects](#) section to edit effects. Then select **Save**.

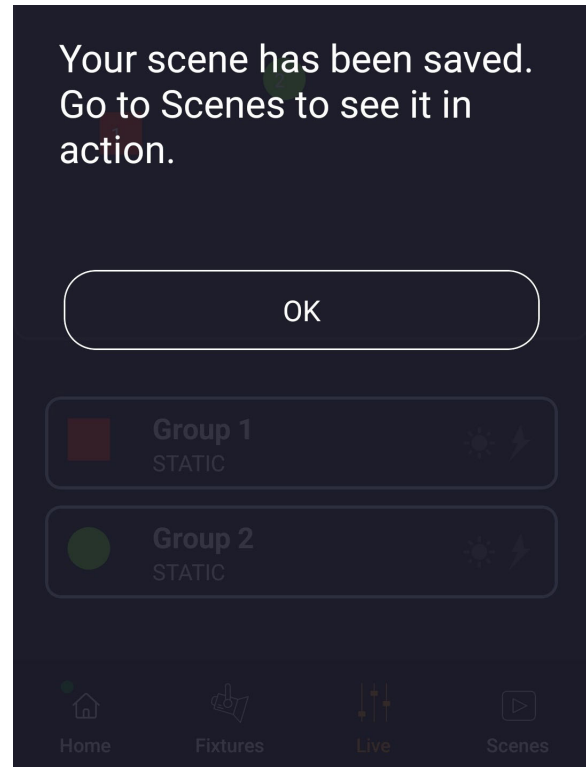
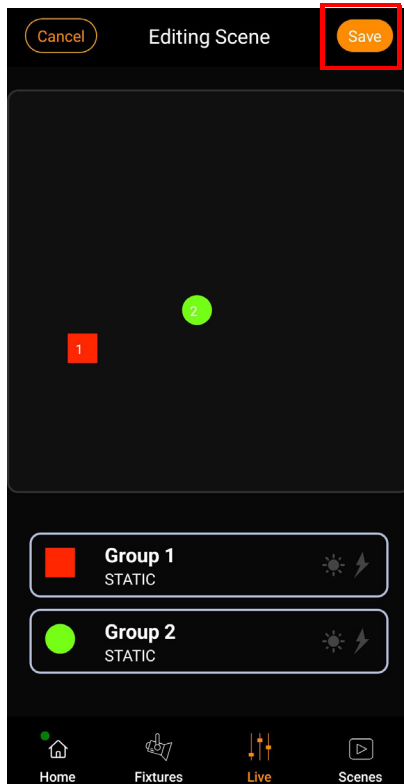

After the scene has saved, a pop-up notification will appear instructing users to visit Scenes to see the live view.

Copy a Scene

To copy an existing scene:

1. Follow steps 1-2 from the [Scene Settings](#) section.
2. Select the copy icon.

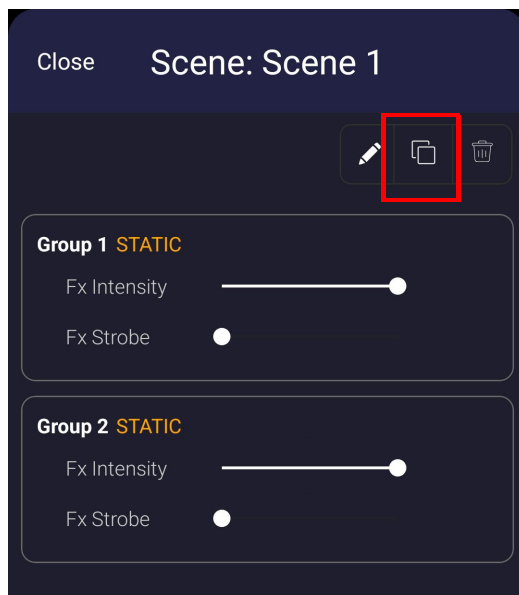

3. A second icon will appear showing the copied scene.

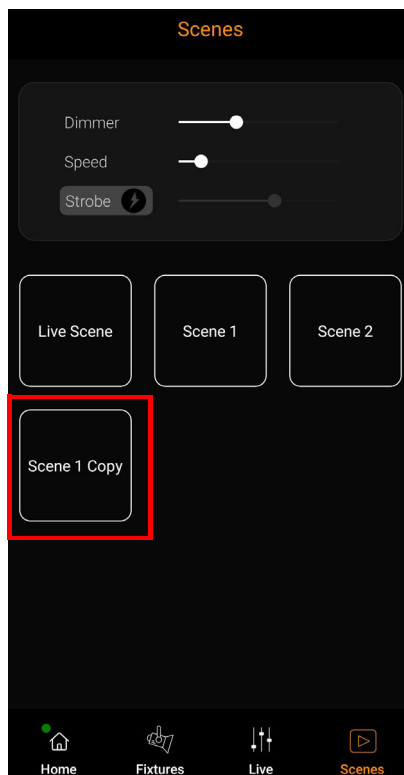

Delete a Scene

To delete a scene:

1. Follow steps 1-2 from the [Scene Settings](#) section.
2. Select the delete icon.

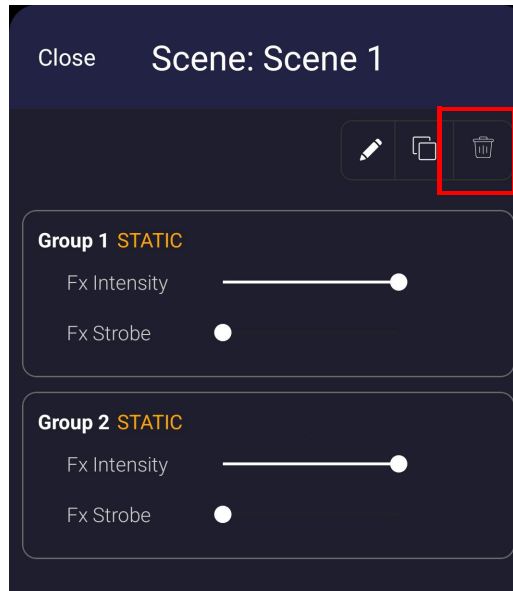

3. The scene will disappear from the main page.

Edit Group Effects

To edit an individual group effect:

1. Follow steps 1-2 from the [Scene Settings](#) section.
2. Identify the desired group(s).

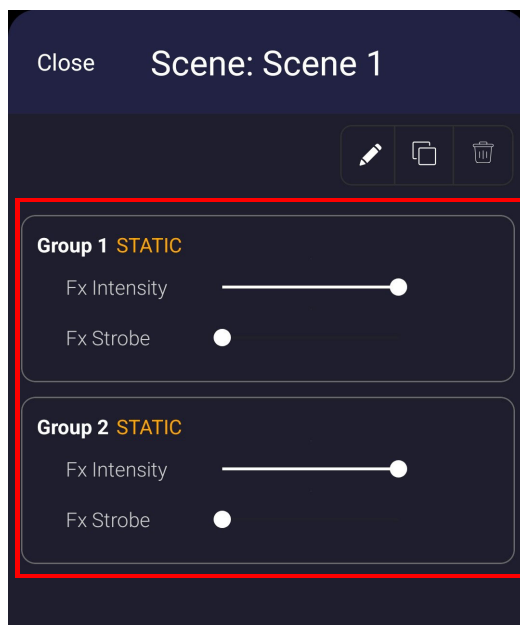

3. Move the FX Intensity and FX Strobe sliders for each individual group.

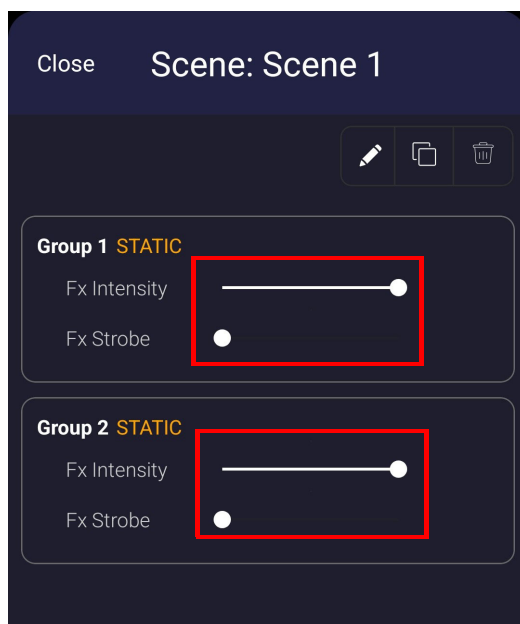

Contact Us

General Information	Technical Support
Chauvet World Headquarters	
Address: 3360 Davie Rd., Suite 509 Davie, FL 33314 Voice: (954) 577-4455 Fax: (954) 929-5560 Toll Free: (800) 762-1084	Voice: (844) 393-7575 Fax: (954) 756-8015 Email: chauvetcs@chauvetlighting.com Website: www.chauvetprofessional.com
Chauvet U.K.	
Address: Pod 1 EVO Park Little Oak Drive, Sherwood Park Nottinghamshire, NG15 0EB UK Voice: +44 (0) 1773 511115 Fax: +44 (0) 1773 511110	Email: UKtech@chauvetlighting.eu Website: www.chauvetprofessional.eu
Chauvet Benelux	
Address: Vaartlaan 9 9800 Deinze Belgium Voice: +32 9 388 93 97	Email: BNLtech@chauvetlighting.eu Website: www.chauvetprofessional.eu
Chauvet France	
Address: 3, Rue Ampère 91380 Chilly-Mazarin France Voice: +33 1 78 85 33 59	Email: FRtech@chauvetlighting.fr Website: www.chauvetprofessional.eu
Chauvet Germany	
Address: Bruno-Bürgel-Str. 11 28759 Bremen Germany Voice: +49 421 62 60 20	Email: DEtech@chauvetlighting.de Website: www.chauvetprofessional.eu
Chauvet Mexico	
Address: Av. de las Partidas 34 - 3B (Entrance by Calle 2) Zona Industrial Lerma Lerma, Edo. de México, CP 52000 Voice: +52 (728) 690-2010	Email: servicio@chauvet.com.mx Website: www.chauvetprofessional.mx

Warranty & Returns

For warranty terms and conditions and return information, please visit our website.

For customers in the United States and Mexico: www.chauvetlighting.com/warranty-registration.

For customers in the United Kingdom, Republic of Ireland, Belgium, the Netherlands, Luxembourg, France, and Germany: www.chauvetlighting.eu/warranty-registration.